

Alu-CabTM

MAKE IT BETTER

FITMENT INSTRUCTIONS

2 Sleeper Rooftop Tent

RT-2S

DISCLAIMER

Preliminary information

All rights reserved.

No part of this document may be reproduced, translated, stored in a retrieval system or transmitted, in any form or by any means, electronic, mechanical, photocopying, recording or otherwise, without prior written permission of the owner.

Review all instruction information carefully before installation.

Any damages, direct or indirect to the installer and/or property due to incorrect installation of any parts are the responsibility of the installer.

Due to the various application and fitment options available, the responsibility lies with the user to ensure all mounting points are secure and tight before every trip. If unsure, consult with your Distributor regarding the operations of our products.

Users are advised to be mindful of the load they are carrying and drive in accordance with road conditions.



Service Enquiries email
queries@alu-cab.com

Installation Instructions

The tables below show the equipment, i.e. tools and fasteners required to install **RT-2S**

Fasteners Supplied				
ITEM NO.	PART NUMBER	Revision	DESCRIPTION	QTY
1	LW-BKT-LB-UNI-P001	01	LIGHTWEIGHT - UNIVERSAL MOUNTING BRACKET	8
2	HEX-M8x80		M8x80 HEX BOLT S/S	16
3	NUT-M8		M8 HEX NUT S/S	16
4	FW-M8		M8x16mm FLAT WASHER S/S - DIN 125	40
5	HEX-M8x40		M8x40 HEX BOLT S/S	16
6	SW-M8		M8 SPRING WASHER S/S	16
7	RUB-INS-30-(105mm)	01	ROOF BOX INSERTION RUBBER - 30x1.5x105mm LONG	8
8	AC001-LD-BAR-FOOT-LP-01	00	LOAD BAR FOOT LOW PROFILE	8
9	HEX-M8x20		M8x20 HEX BOLT S/S	24
10	NCAP-M8		NUT CAP-08mm	24
11	NY-M8		M8 NYLOC NUT S/S	24
12	RUB-INS-(1000mm)	00	TENT MOUNTING KIT INSERTION RUBBER (1000mm)	1

Tools & Items Required
13mm Socket
Spanner
Wrench

More details on pg 8 & 11.

Lay out all parts provided on a table or flat surface, to ensure that all required parts are accounted for,

Installation Instructions

I. Preliminary Information

RT-2S may be installed to open on either side. Choose a desired side for your vehicle.



Installation Instructions

II. Preliminary Information

RT-2S has the following rubber [RUB-INS-(1000mm)] included in the mounting kit, which can be used to damper any rattling that may occur between the load bars and tent.

A 1 meter roll is supplied which can be cut down and used at the contact point areas between the Tent and Load Bars.

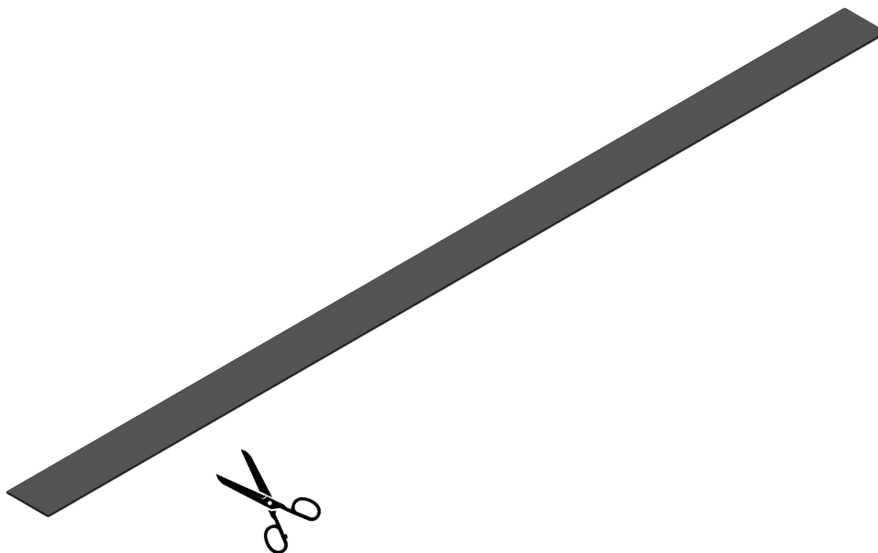

Installation Instructions

III. Preliminary Information

For a standard fitment, **x2 Alu-Cab 1450 Load bars** are the recommended Load bars for RT-2S.

Non Alu-Cab load bars can still be used as long as they can handle the weight of RT-2S.

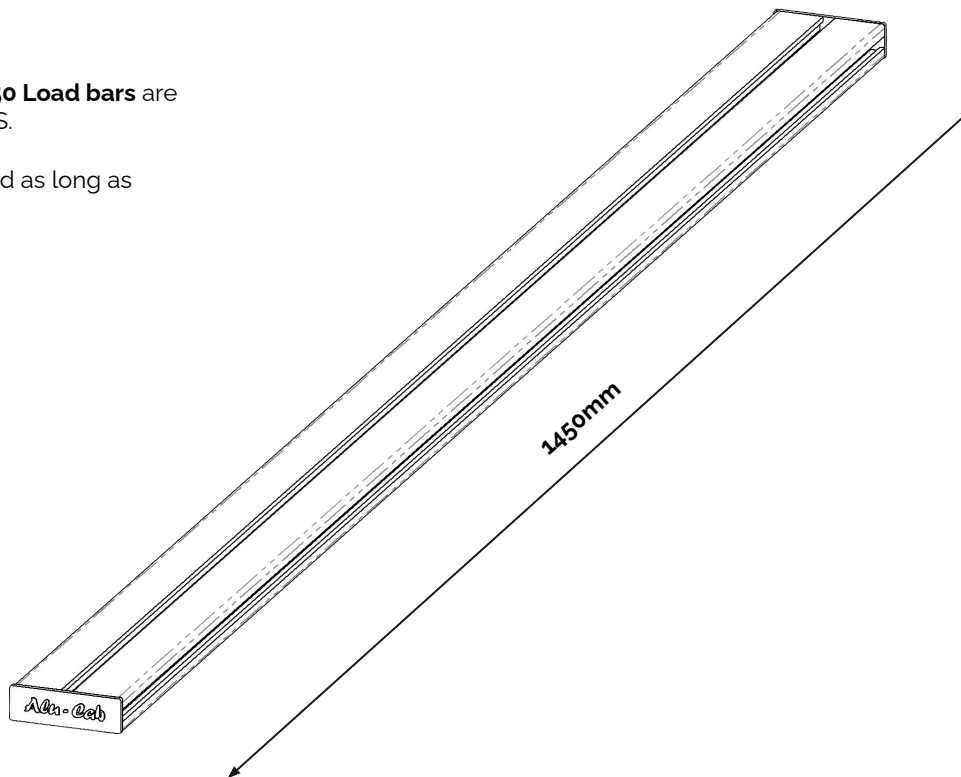

Installation Instructions

IV. Preliminary Information

There are 2 types of brackets supplied for installation, choose the relevant option for your fitment shown below.

OPTION A: Use the following brackets if installing to **Alu-Cab Load bars**.

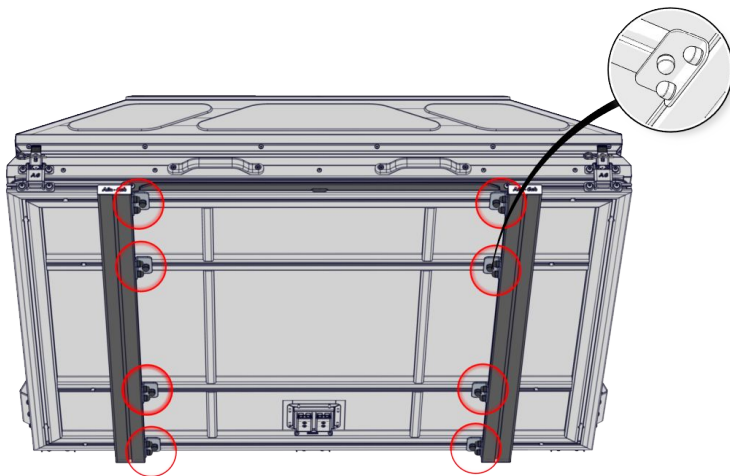

OPTION B: Use the following brackets if installing to **NON Alu-Cab Load bars**, or as an **alternative option to mount on Alu-cab load bars**.

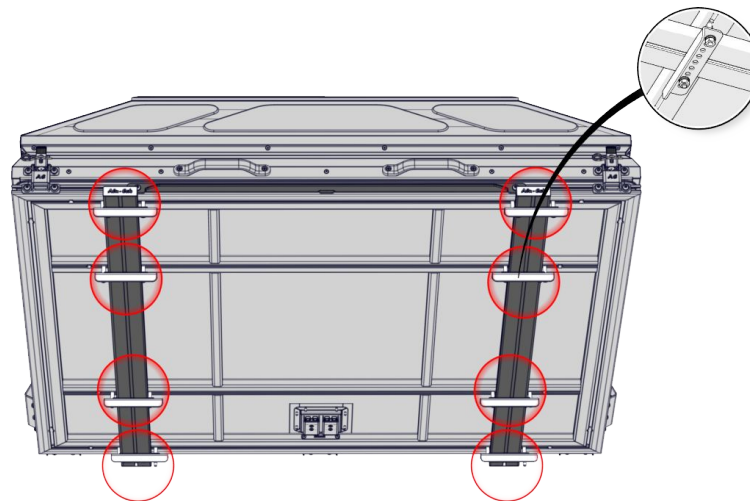

Installation Instructions

OPTION A: PARTS LIST

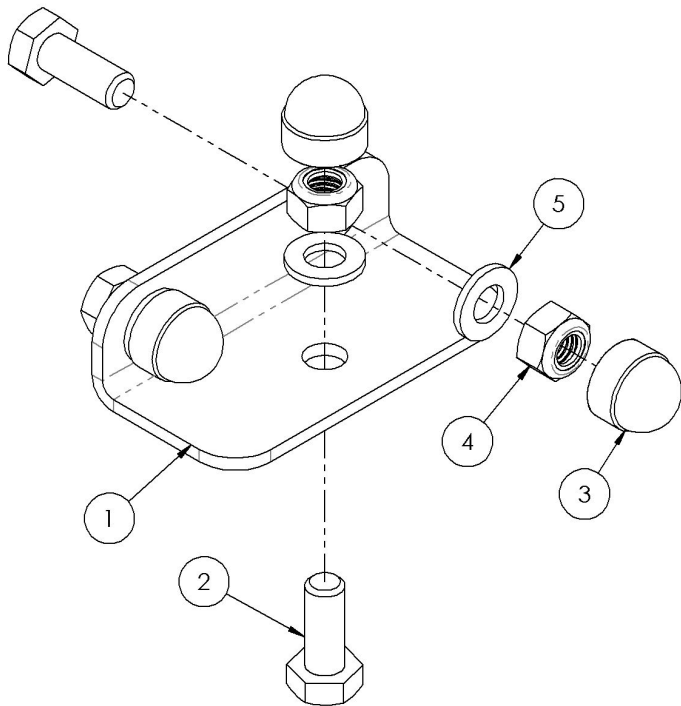

ITEM NO.	PART NUMBER	DESCRIPTION	QTY
1	AC001-LD-BAR-FOOT-LP-01	LOAD BAR FOOT LOW PROFILE	8
2	HEX-M8x20	M8x20 HEX BOLT S/S	24
3	NCAP-M8	NUT CAP	24
4	NY-M8	M8 NYLOC NUT S/S	24
5	FW-M8	M8x16mm FLAT WASHER S/S	24

Installation Instructions

STEP
1a

OPTION A: Fastening to Alu-Cab Load bars

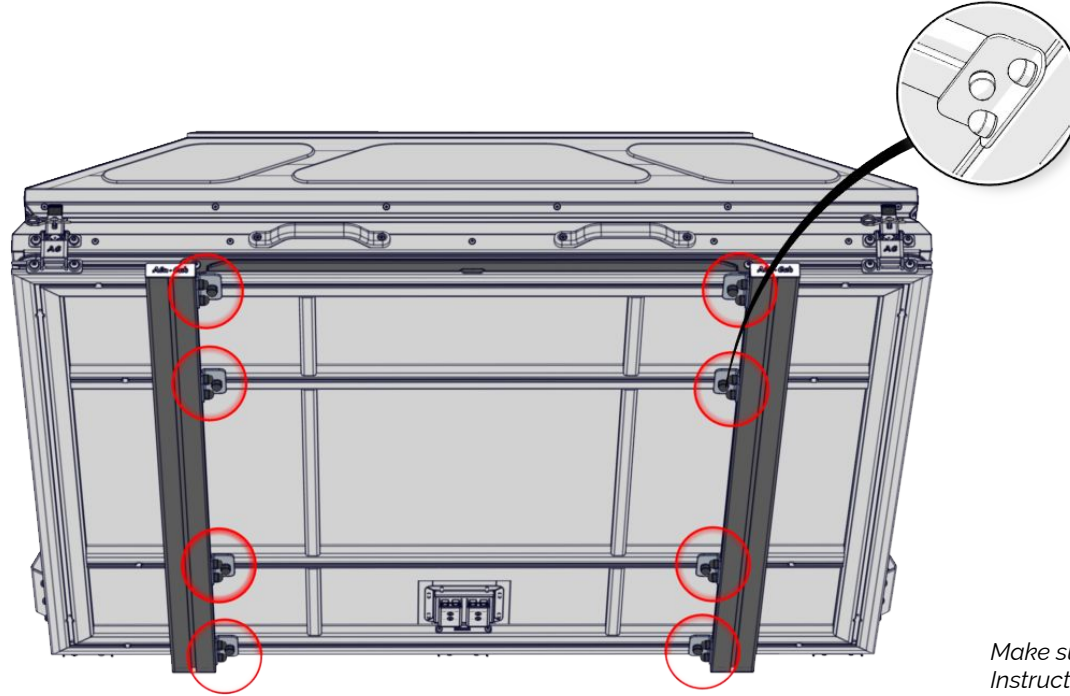

NB. Ensure the load bars are spaced correctly on your canopy/vehicle. Between 900mm-700mm apart

1. Slide x4 M8 Bolts into the centre nut slot extrusions and outer edge nut slot extrusions. 2 Bolts per nut slot extrusion.
2. Fasten the low profile load bar feet to the inserted bolts.
3. Fasten down to the Alu-Cab load bars with the correct nuts and washers (see pg 8) once the correct spacing identified for your fitment.
4. Add the plastic nut caps.

Make sure to check your load bar Fitment Instructions for fitting of Load Bars.

*Alu-Cab Load Bar instructions can be found here:
<https://www.alu-cab.com/products/load-bars/>*

Installation Instructions

STEP
2a

OPTION A: Final Fitment

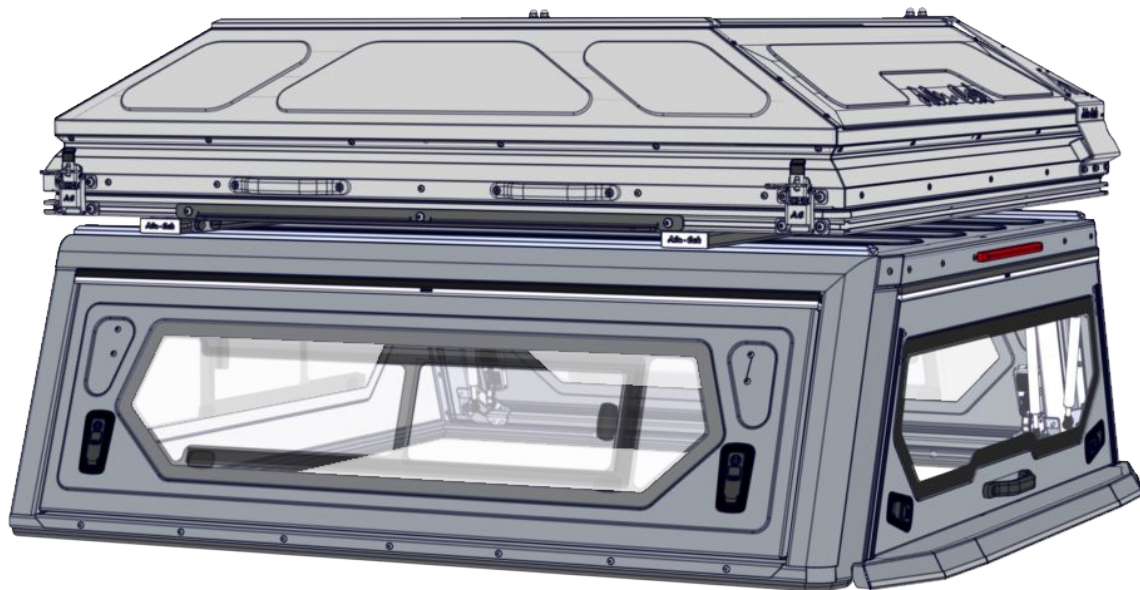

Check mounting hardware
regularly to ensure your safety.

Installation Instructions

OPTION B: PARTS LIST

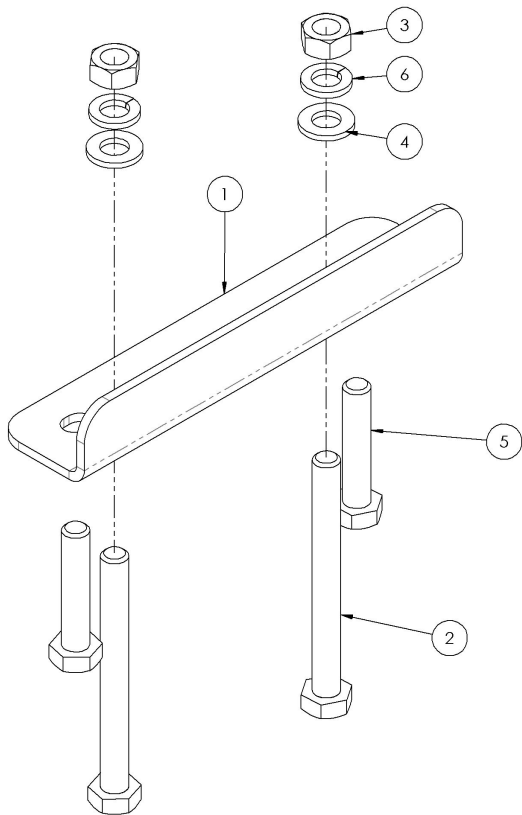

ITEM NO.	PART NUMBER	DESCRIPTION	QTY
1	LW-BKT-LB-UNI-P001	UNIVERSAL MOUNTING BRACKET	8
2	HEX-M8x80	M8x80 HEX BOLT S/S	16
3	NUT-M8	M8 HEX BUT S/S	16
4	FW-M8	M8x16mm FLAT WASHER S/S NYLOC NUT S/S	16
5	HEX-M8x40	M8x40 HEX BOLT S/S	16
6	SW-M8	M8 SPRING WASHER S/s	16

Extra bolts included for a shorter fitment. Choose an appropriate size for your load bars (x2 bolts per bracket)

Installation Instructions

OPTION B: PARTS LIST

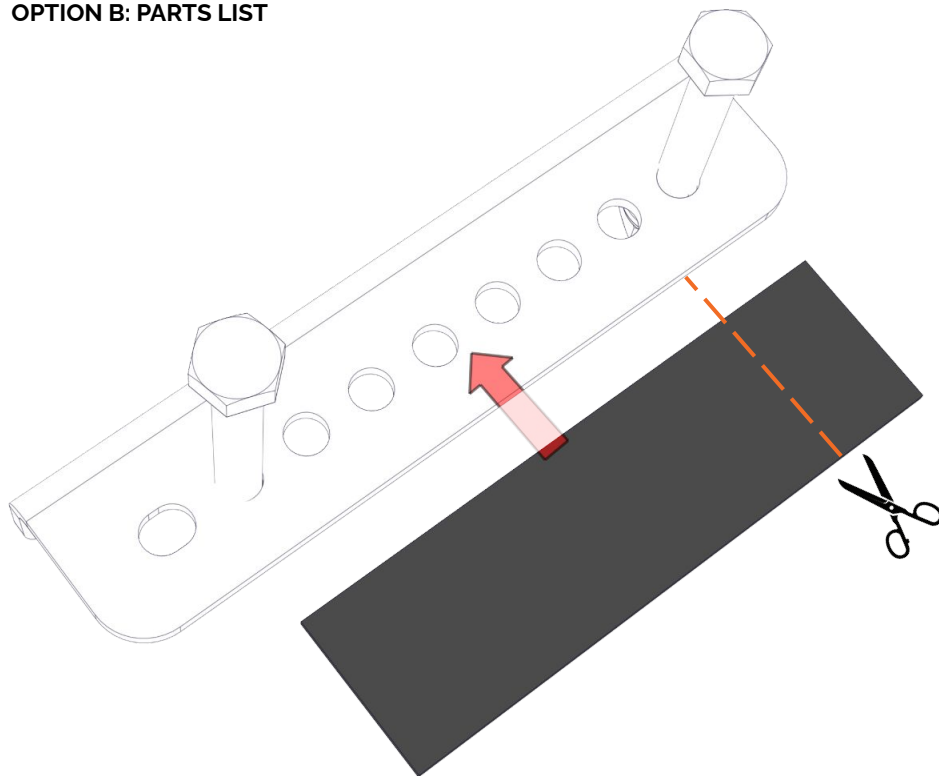

A rubber is included for the universal mounting bracket.

Trim the rubber down to the width of your load bar.

Installation Instructions

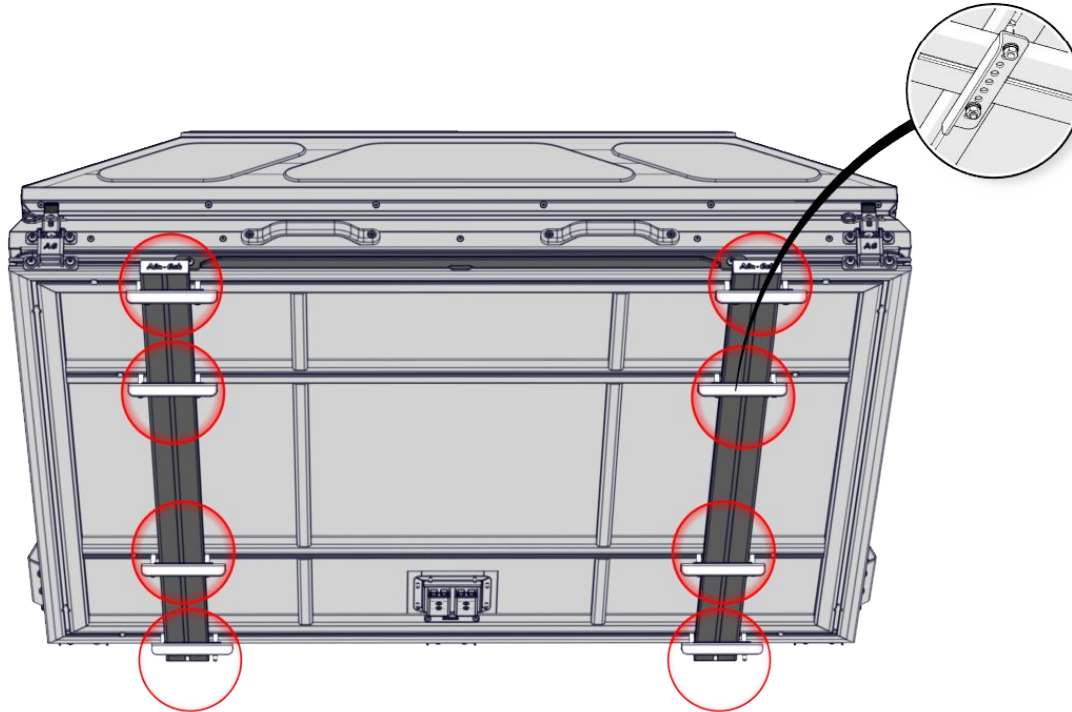
**STEP
1b****OPTION B: Fastening to Non Alu-Cab Load bars
(Or alternative to Alu-Cab Bars)**

NB. Ensure the load bars are spaced correctly on your canopy/vehicle.

1. Choose an appropriate bolt length for your load bars.
2. Slide x16 M8 Bolts into the 2 centre nut slot extrusions and outer edge nut slot extrusions. 4 Bolts per nut slot extrusion.
3. Ensure rubbers are placed between the bracket and load bar.
4. Fasten the universal mounting brackets to the load bars with the correct nuts and washers (see pg 11) once the correct spacing identified for your fitment.

Make sure to check your Load Bar Fitment Instructions for fitting of Load Bars..

Installation Instructions

STEP
2b

OPTION B: Final Fitment

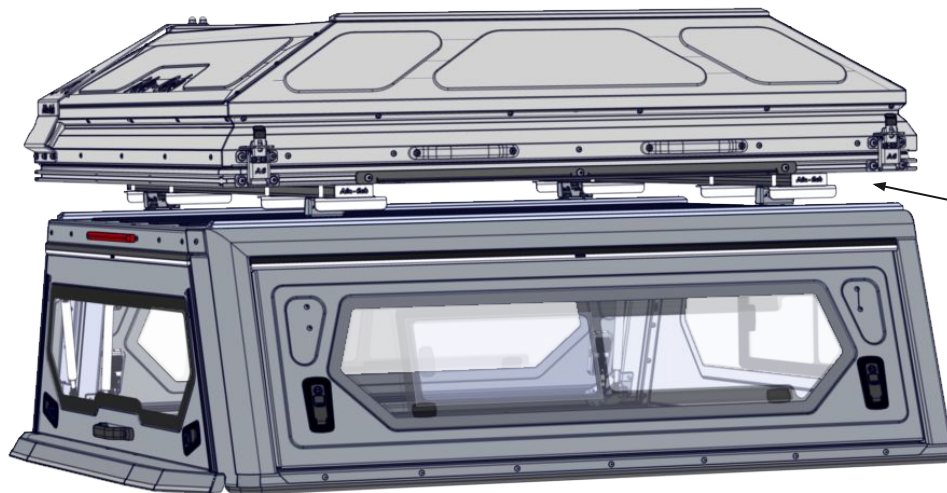

Ensure enough clearance for brackets.

Check mounting hardware regularly to ensure your safety.

Installation Instructions

Miscellaneous

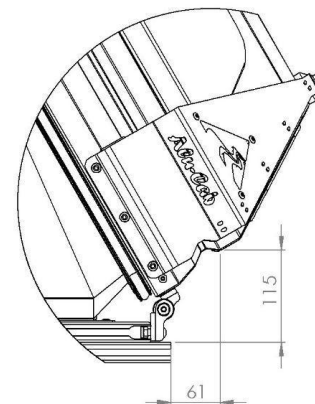
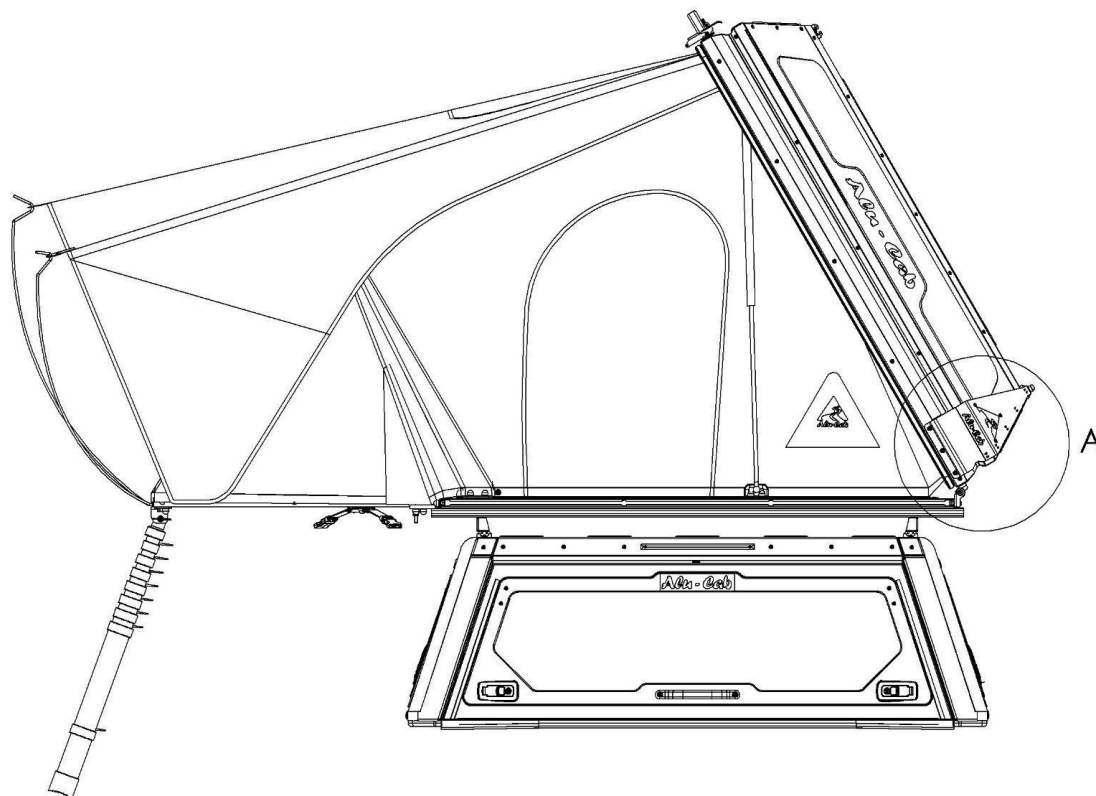

DETAIL A

NB: If installing any other accessory on the lid opening side, ensure there is **enough clearance** for the lid to open freely.

DISCLAIMER

All rights reserved. No part of this website may be reproduced, translated, stored in a retrieval system, or transmitted, in any form or by any means, electronic, mechanical, photocopying, recording or otherwise, without prior written permission of the owner.

Review all instructions information carefully before installation.

Any damages, direct or incidental to the installer and/or property due to incorrect installation of any parts are the responsibility of the installer. Due to the various applications and fitment options available, the responsibility lies with the user to ensure all mounting points are secure and tight before every trip.

If unsure, consult with your Distributor regarding the operations of our products.

Users are advised to be mindful of the load they are carrying and drive in accordance with road conditions.

WARNING

Always wear appropriate PPE (Personal protection equipment) when fitting our products. Although the mounting kit is designed to be DIY, if you have any doubts or concerns, contact an accredited fitment centre to carry out the work. Alu-Cab will not be liable for any injury to persons, and/or damage to products and/or vehicles.

While Alu-Cab Holdings takes reasonable measures to ensure that the contents of this Website are accurate and complete, Alu-Cab Holdings makes no representations or warranties, whether express or implied, as to the quality, timeliness, operation, integrity, availability or functionality of this Website or as to the accuracy, completeness or reliability of any information on this Website. Alu-Cab Holdings reserves the right to make changes, corrections and/or improvements to the information and to the products and programs described in such information, at any time without notice.

Alu-Cab Holdings will use reasonable endeavours to maintain the availability of the Website, except during scheduled maintenance periods, and reserves the right to discontinue providing the Website or the service or any part thereof with or without notice to you. Any person who accesses this Website or relies on this Website or on the information contained in this Website does so at his or her own risk.

Occasionally, at our discretion, we may include or offer third-party products or services on our website. These third-party sites have separate and independent privacy policies. We therefore have no responsibility or liability for the content and activities of these linked sites. Nonetheless, we seek to protect the integrity of our site and welcome any feedback about these sites.