

Alu-CabTM

MAKE IT BETTER

FITMENT INSTRUCTIONS

ModCap Family Camper

CC2-BO-FAM-TENT

Installation Instructions

Installation and fitment instructions includes the tools required, fasteners included in the kit, and the hardware included in the kit.

Please follow the instructions and check installation steps with the images in this document.

Alu-Cab recommends that all sealing work is allowed to cure for 24 hours, after which you may drive the vehicle on normal paved roads. Before driving off-road with your Alu-Cab product or operating your roof conversion, an additional cure period of 48 hours is required.

Failure to follow these instructions will void your warranty. Please ensure that you follow the sealant manufacturers curing time as per their technical data sheet.

These times may differ slightly from the times we have recommended.

Service Enquiries email
queries@alu-cab.com



Installation Instructions

ModCAP Family Camper

How to use this guide

1 The following guide uses the CC2-BO-FAM-DC-TMK (Tent Mounting Kit) to demonstrate fitment.

This guide can also be used for the following mounting kits:

1. CC2-BO-FAM-FSL-TMK
2. CC2-BO-FAM-FSS-TMK
3. CC2-BO-FAM-XC-TMK
4. CC2-BO-FAM-LCD-TMK
5. CC2-BO-FAM-DC-TMK-HP

There are 3 main items required for this guide:

- A. 1 Tent
- B. 1 Mounting Kit
- C. 1 Base

A CC2-BO-FAM-TENT



B

CC2-BO-FAM-DC-TMK /HP
OR
CC2-BO-FAM-FSL-TMK
OR
CC2-BO-FAM-FSS-TMK
OR
CC2-BO-FAM-XC-TMK
OR
CC2-BO-FAM-LCD-TMK



C

CC2-BO-DC-BASE
OR
CC2-BO-FSL-BASE
OR
CC2-BO-FSS-BASE
OR
CC2-BO-XC-BASE
OR
CC2-BO-LCD-BASE

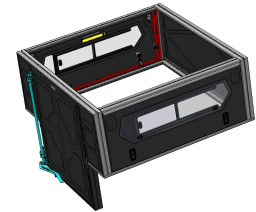

Installation Instructions

ModCAP Family Camper – Tools, Fasteners & Hardware

1.1

Tools & Items Required

| |
|--------------------------|
| 10mm Ring Spanner/Socket |
| 13mm Ring Spanner/Socket |
| Torque Wrench |
| 4mm Allen Key size |

1.2

Fasteners Supplied

Fasteners required per assembly can be found on pages:
16, 18, 19, 20, 21, 30, 31, 36

Installation Instructions

ModCAP Family Camper – Tools, Fasteners & Hardware

1.3

DC TMK



| ITEM NO. | PART NUMBER | Revision | DESCRIPTION | QTY |
|----------|----------------------------|----------|--|-----|
| 1 | CC-BO-BASE-DC-RUB | 02 | CC BO DC RUBBER SEAL | 1 |
| 2 | CC2-BO-FAM-TMK-A02 | 00 | FAMILY CAMPER REAR MOUNTING BRACKET ASSEMBLY | 3 |
| 3 | CC2-BO-FAM-TMK-A04 | 00 | FAMILY CAMPER FRONT MOUNTING ASSEMBLY | 1 |
| 4 | CC2-BO-FAM-TMK-A03 | 01 | FAMILY CAMPER RHS MOUNTING BRACKET ASSEMBLY | 3 |
| 5 | CC2-BO-FAM-TMK-A01 | 01 | FAMILY CAMPER LHS MOUNTING BRACKET ASSEMBLY | 2 |
| 6 | CC2-BO-FAM-DC-TMK-A01 | 01 | FAMILY CAMPER DC OVERHANG BRACKET ASSEMBLY | 1 |
| 7 | CC2-BO-FAM-TMK-A07 | 01 | FAMILY CAMPER PIPE SUPPORT WITH BOLTS | 1 |
| 8 | CC2-BO-FAM-TMK-A05 | 01 | FAMILY CAMPER BED SUPPORT ASSEMBLY | 1 |
| 9 | CC2-BO-FAM-TMK-A011 | 00 | FAMILY CAMPER LHS MOUNTING BRACKET ASSEMBLY - CORNER | 1 |
| 10 | AC001-HND-ADPT-PLT-ASSY-01 | 00 | GRAB HANDLE ADAPTER PLATE ASSEMBLY | 1 |

1.4

XC TMK

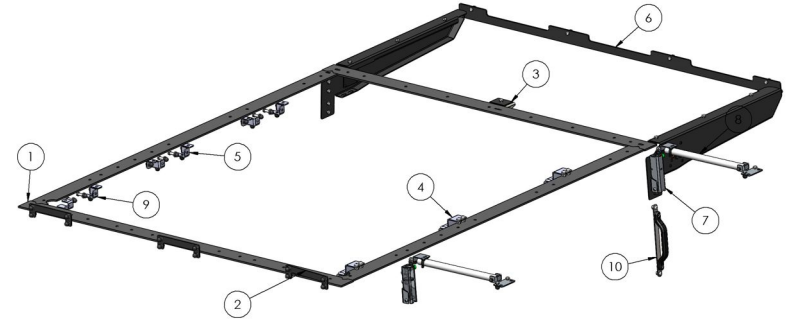

| ITEM NO. | PART NUMBER | Revision | DESCRIPTION | QTY |
|----------|----------------------------|----------|--|-----|
| 1 | CC-BO-BASE-XC-RUB | 02 | CC BO XC RUBBER SEAL | 1 |
| 2 | CC2-BO-FAM-TMK-A02 | 00 | FAMILY CAMPER REAR MOUNTING BRACKET ASSEMBLY | 3 |
| 3 | CC2-BO-FAM-TMK-A04 | 00 | FAMILY CAMPER FRONT MOUNTING ASSEMBLY | 1 |
| 4 | CC2-BO-FAM-TMK-A03 | 01 | FAMILY CAMPER RHS MOUNTING BRACKET ASSEMBLY | 3 |
| 5 | CC2-BO-FAM-TMK-A01 | 01 | FAMILY CAMPER LHS MOUNTING BRACKET ASSEMBLY | 2 |
| 6 | CC2-BO-FAM-XC-TMK-A01 | 02 | FAMILY CAMPER XC OVERHANG BRACKET ASSEMBLY | 1 |
| 7 | CC2-BO-FAM-TMK-A07 | 01 | FAMILY CAMPER PIPE SUPPORT WITH BOLTS | 2 |
| 8 | CC2-BO-FAM-TMK-A05 | 01 | FAMILY CAMPER BED SUPPORT ASSEMBLY | 2 |
| 9 | CC2-BO-FAM-TMK-A011 | 00 | FAMILY CAMPER LHS MOUNTING BRACKET ASSEMBLY - CORNER | 1 |
| 10 | AC001-HND-ADPT-PLT-ASSY-01 | 00 | GRAB HANDLE ADAPTER PLATE ASSEMBLY | 1 |

Installation Instructions

ModCAP Family Camper – Tools, Fasteners & Hardware

1.5

FSS TMK

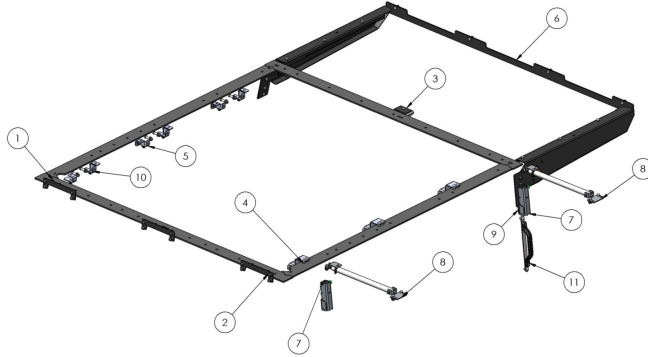

| ITEM NO. | PART NUMBER | Revision | DESCRIPTION | QTY |
|----------|----------------------------|----------|--|-----|
| 1 | CC-BO-BASE-FSS-RUB | 02 | CC BO FSS RUBBER SEAL | 1 |
| 2 | CC2-BO-FAM-TMK-A02 | 00 | FAMILY CAMPER REAR MOUNTING BRACKET ASSEMBLY | 3 |
| 3 | CC2-BO-FAM-TMK-A04 | 00 | FAMILY CAMPER FRONT MOUNTING ASSEMBLY | 1 |
| 4 | CC2-BO-FAM-TMK-A03 | 01 | FAMILY CAMPER RHS MOUNTING BRACKET ASSEMBLY | 3 |
| 5 | CC2-BO-FAM-TMK-A01 | 01 | FAMILY CAMPER LHS MOUNTING BRACKET ASSEMBLY | 2 |
| 6 | CC2-BO-FAM-FSS-TMK-A01 | 02 | FAMILY CAMPER FSS OVERHANG BRACKET ASSEMBLY | 1 |
| 7 | CC2-BO-FAM-TMK-A07 | 01 | FAMILY CAMPER PIPE SUPPORT WITH BOLTS | 2 |
| 8 | CC2-BO-FAM-TMK-A05 | 01 | FAMILY CAMPER BED SUPPORT ASSEMBLY | 2 |
| 9 | CC2-BO-FAM-TMK-P014 | 00 | FAMILY CAMPER FSS/FSL MOUNTING SPACER | 1 |
| 10 | CC2-BO-FAM-TMK-A011 | 00 | FAMILY CAMPER LHS MOUNTING BRACKET ASSEMBLY - CORNER | 1 |
| 11 | AC001-HND-ADPT-PLT-ASSY-01 | 00 | GRAB HANDLE ADAPTER PLATE ASSEMBLY | 1 |

1.6

FSL TMK

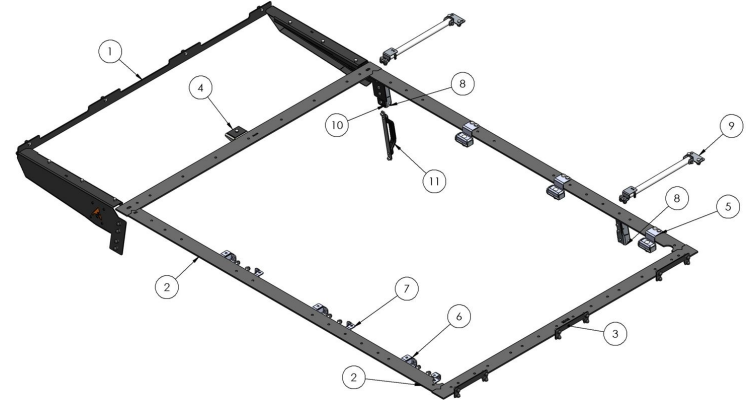

| ITEM NO. | PART NUMBER | Revision | DESCRIPTION | QTY |
|----------|----------------------------|----------|--|-----|
| 1 | CC2-BO-FAM-FSL-TMK-A01 | 02 | FAMILY CAMPER FSL OVERHANG BRACKET ASSEMBLY | 1 |
| 2 | CC-BO-BASE-FSL-RUB | 02 | CC BO FSL RUBBER SEAL | 1 |
| 3 | CC2-BO-FAM-TMK-A02 | 00 | FAMILY CAMPER REAR MOUNTING BRACKET ASSEMBLY | 3 |
| 4 | CC2-BO-FAM-TMK-A04 | 00 | FAMILY CAMPER FRONT MOUNTING ASSEMBLY | 1 |
| 5 | CC2-BO-FAM-TMK-A03 | 01 | FAMILY CAMPER RHS MOUNTING BRACKET ASSEMBLY | 3 |
| 6 | CC2-BO-FAM-TMK-A011 | 00 | FAMILY CAMPER LHS MOUNTING BRACKET ASSEMBLY - CORNER | 1 |
| 7 | CC2-BO-FAM-TMK-A01 | 01 | FAMILY CAMPER LHS MOUNTING BRACKET ASSEMBLY | 2 |
| 8 | CC2-BO-FAM-TMK-A07 | 01 | FAMILY CAMPER PIPE SUPPORT WITH BOLTS | 2 |
| 9 | CC2-BO-FAM-TMK-A05 | 01 | FAMILY CAMPER BED SUPPORT ASSEMBLY | 2 |
| 10 | CC2-BO-FAM-TMK-P014 | 00 | FAMILY CAMPER FSS/FSL MOUNTING SPACER | 1 |
| 11 | AC001-HND-ADPT-PLT-ASSY-01 | 00 | GRAB HANDLE ADAPTER PLATE ASSEMBLY | 1 |

Installation Instructions

ModCAP Family Camper – Tools, Fasteners & Hardware

1.7

LCD TMK

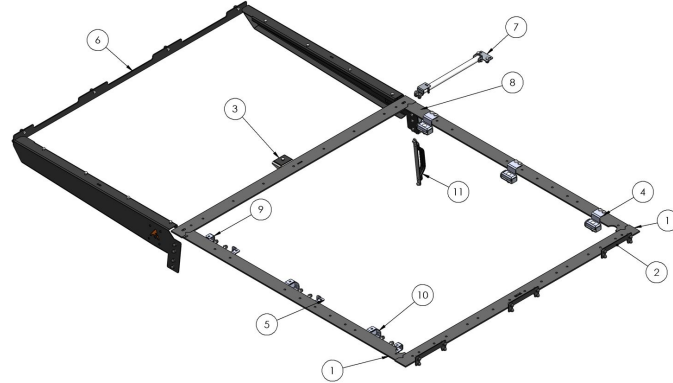

| ITEM NO. | PART NUMBER | Revision | DESCRIPTION | QTY |
|----------|----------------------------|----------|---|-----|
| 1 | CC-BO-BASE-LCD-RUB | 02 | CC BO LCD RUBBER SEAL | 1 |
| 2 | CC2-BO-FAM-TMK-A02 | 00 | FAMILY CAMPER REAR MOUNTING BRACKET ASSEMBLY | 3 |
| 3 | CC2-BO-FAM-TMK-A04 | 00 | FAMILY CAMPER FRONT MOUNTING ASSEMBLY | 1 |
| 4 | CC2-BO-FAM-TMK-A03 | 01 | FAMILY CAMPER RHS MOUNTING BRACKET ASSEMBLY | 3 |
| 5 | CC2-BO-FAM-TMK-A01 | 01 | FAMILY CAMPER LHS MOUNTING BRACKET ASSEMBLY | 1 |
| 6 | CC2-BO-FAM-LCD-TMK-A01 | 04 | FAMILY CAMPER LCD OVERHANG BRACKET ASSEMBLY | 1 |
| 7 | CC2-BO-FAM-TMK-A05 | 01 | FAMILY CAMPER BED SUPPORT ASSEMBLY | 1 |
| 8 | CC2-BO-FAM-TMK-A07 | 01 | FAMILY CAMPER PIPE SUPPORT WITH BOLTS | 1 |
| 9 | CC2-BO-FAM-TMK-A12 | 00 | FAMILY CAMPER LHS FRONT MOUNTING BRACKET ASSEMBLY (LCD) | 1 |
| 10 | CC2-BO-FAM-TMK-A011 | 00 | FAMILY CAMPER LHS MOUNTING BRACKET ASSEMBLY - CORNER | 1 |
| 11 | AC001-HND-ADPT-PLT-ASSY-01 | 00 | GRAB HANDLE ADAPTER PLATE ASSEMBLY | 1 |

DC TMK HP

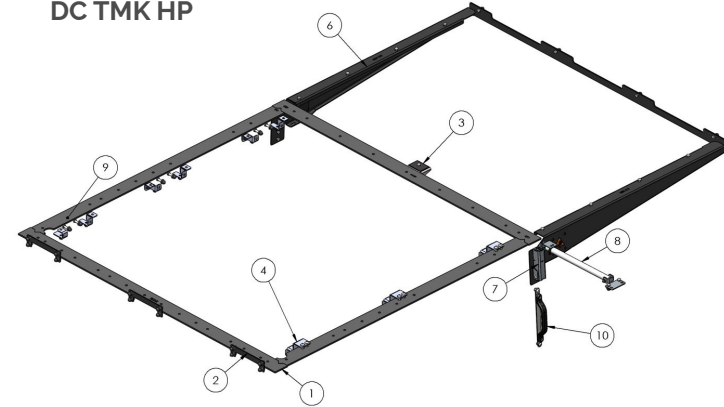

| ITEM NO. | PART NUMBER | Revision | DESCRIPTION | QTY |
|----------|----------------------------|----------|--|-----|
| 1 | CC-BO-BASE-DC-RUB | 02 | CC BO DC RUBBER SEAL | 1 |
| 2 | CC2-BO-FAM-TMK-A02 | 00 | FAMILY CAMPER REAR MOUNTING BRACKET ASSEMBLY | 3 |
| 3 | CC2-BO-FAM-TMK-A04 | 00 | FAMILY CAMPER FRONT MOUNTING ASSEMBLY | 1 |
| 4 | CC2-BO-FAM-TMK-A03 | 01 | FAMILY CAMPER RHS MOUNTING BRACKET ASSEMBLY | 3 |
| 5 | CC2-BO-FAM-TMK-A01 | 01 | FAMILY CAMPER LHS MOUNTING BRACKET ASSEMBLY | 2 |
| 6 | CC2-BO-FAM-DC-TMK-HP-A01 | 02 | FAMILY CAMPER DC OVERHANG BRACKET ASSEMBLY HP | 1 |
| 7 | CC2-BO-FAM-TMK-A07 | 01 | FAMILY CAMPER PIPE SUPPORT WITH BOLTS | 1 |
| 8 | CC2-BO-FAM-TMK-A05 | 01 | FAMILY CAMPER BED SUPPORT ASSEMBLY | 1 |
| 9 | CC2-BO-FAM-TMK-A011 | 00 | FAMILY CAMPER LHS MOUNTING BRACKET ASSEMBLY - CORNER | 1 |
| 10 | AC001-HND-ADPT-PLT-ASSY-01 | 00 | GRAB HANDLE ADAPTER PLATE ASSEMBLY | 1 |

Installation Instructions

ModCAP Family Camper – Tools, Fasteners & Hardware

2

ModCAP Base preparation

Lay the appropriate rubbers down to the ModCAP base as shown.

NB. Holes in rubbers are irrelevant for this fitment

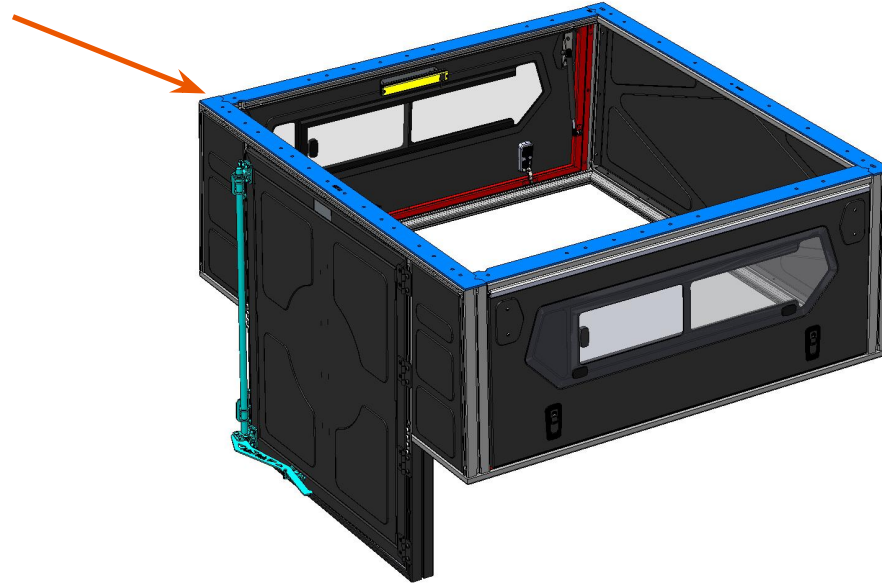

Installation Instructions

ModCAP Family Camper – Tools, Fasteners & Hardware

2.1

ModCAP Base preparation

Slide M8x35 HEX bolts and M8x20 HEX bolts at the left side (When facing rear door) of the ModCAP base as shown.

NOTE: The M8x20 and M8x35 bolts shown here are from the assembly below. See pg 18-20.

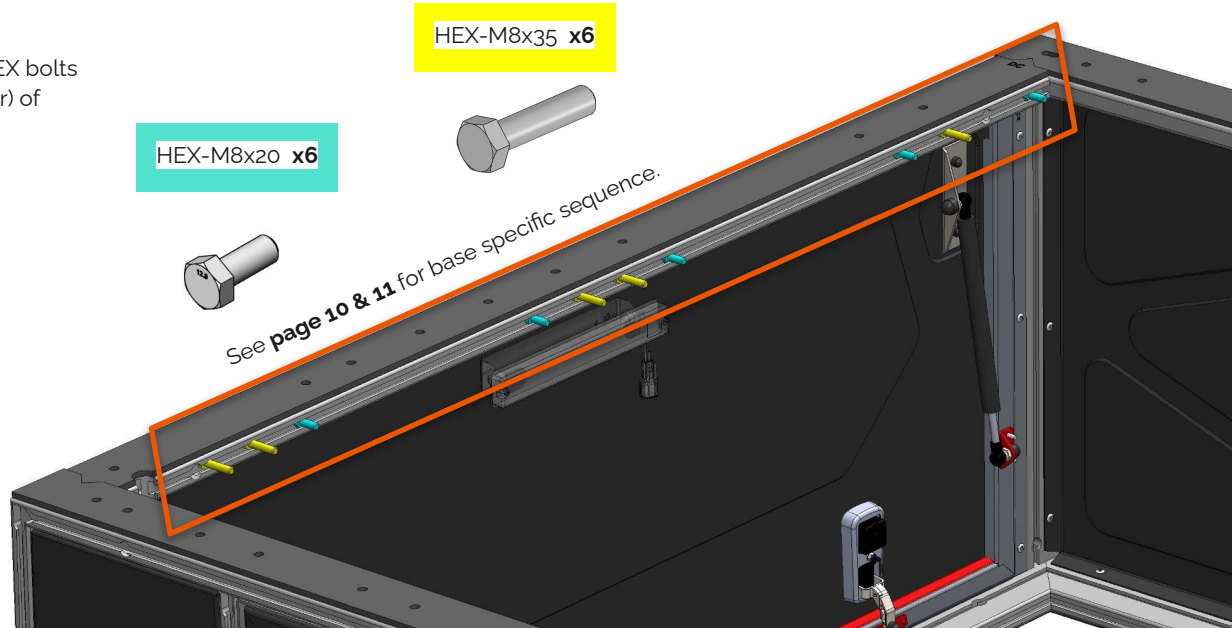
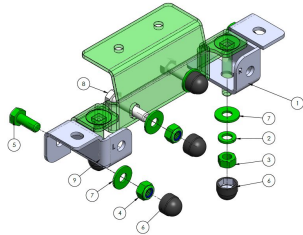

Installation Instructions

ModCAP Family Camper – Tools, Fasteners & Hardware

2.1

ModCAP Base preparation

The following shows the sequence to follow per base. **NB.** Slide them in the **exact sequence** shown in the image.

HEX-M8x20



HEX-M8x35

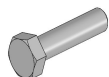

FSS, FSL, XC

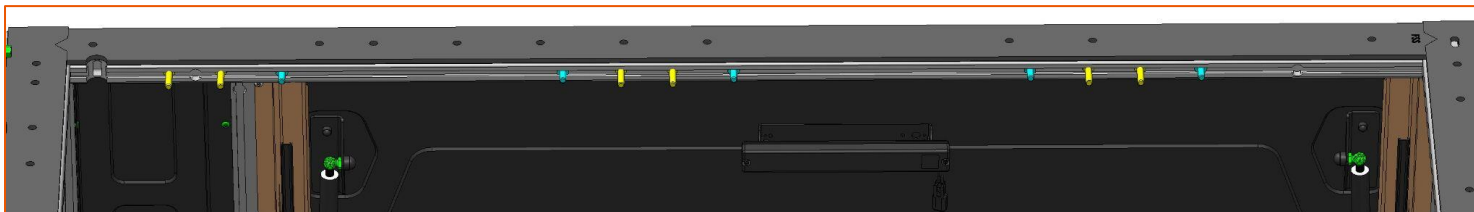

LCD

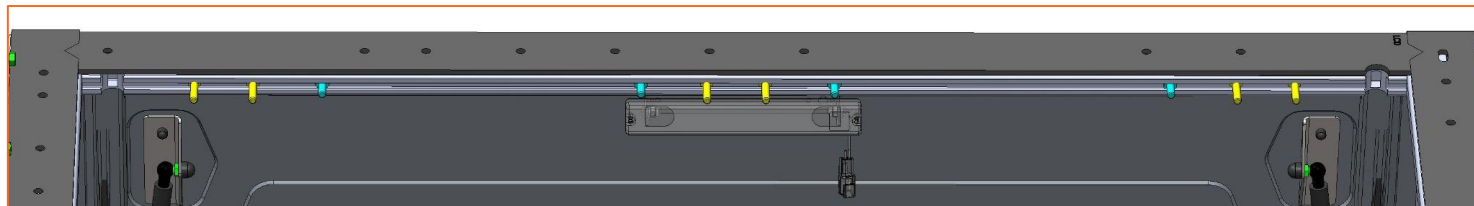

Installation Instructions

ModCAP Family Camper – Tools, Fasteners & Hardware

ModCAP Base preparation (NOTE FOR DC BASE)

2.2

The following bolt may be omitted for DC bases as it will run at the nut slot opening.

HEX-M8x35

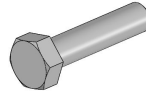

DC

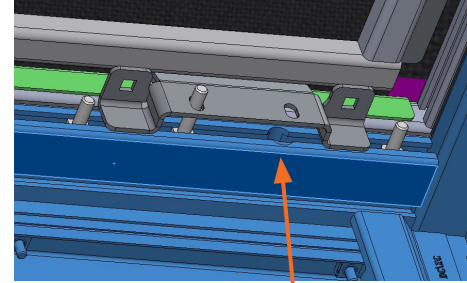

Installation Instructions

ModCAP Family Camper – Tools, Fasteners & Hardware

3

Camper + Base Alignment

Lift the Camper using a Gantry crane and ensure the straps run under the Camper when lifting.

Thereafter, steadily drop the camper closer to the base.

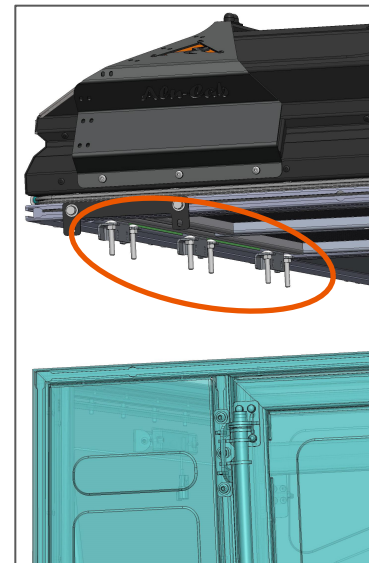

NB. Be mindful of internal brackets and bolts when placing onto base.

Installation Instructions

ModCAP Family Camper – Tools, Fasteners & Hardware

3.1

Camper + Base Alignment

As the camper gets closer to the ModCAP base, align the **M8x35 HEX bolts** to the bottom brackets on the Camper and get them through their respective holes.

NB. The **M8x20 HEX bolts** should lie on the **left** and **right** sides of the Camper's bottom brackets as shown below.

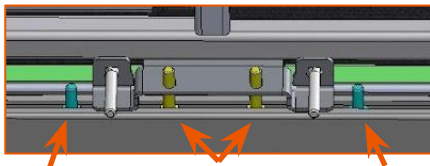

HEX-M8x20

HEX-M8x35

HEX-M8x20

Once the M8x35 Hex bolts are through the brackets, the Camper can be dropped to the ModCAP base.

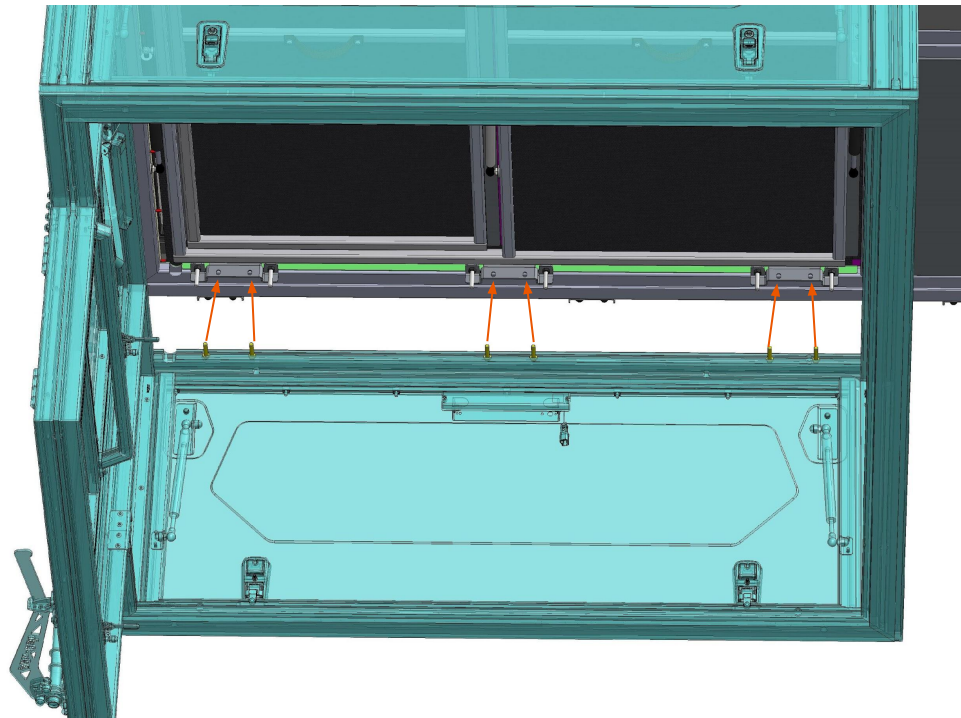

Installation Instructions

ModCAP Family Camper – Tools, Fasteners & Hardware

3.2

Camper + Base Alignment

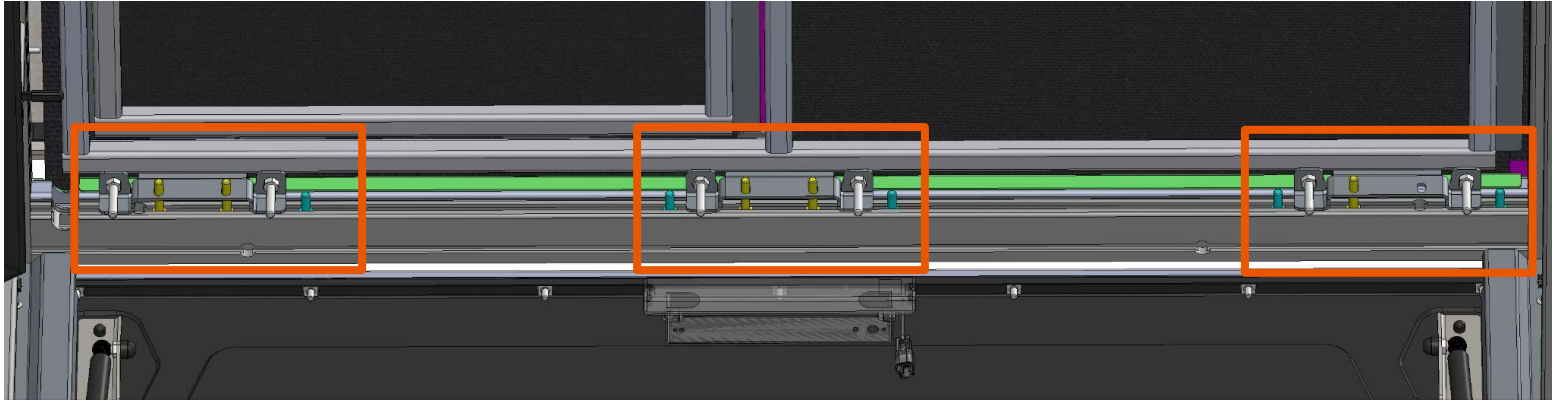

With the camper now on top of the ModCAP base, the pre-inserted bolts should now be in the sequence shown in the image above (DC shown).

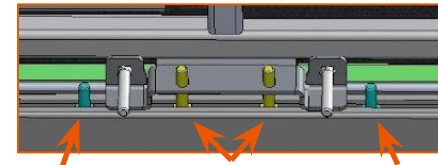

HEX-M8x20

HEX-M8x35

HEX-M8x20

Installation Instructions

ModCAP Family Camper – Tools, Fasteners & Hardware

3.3

Camper + Base Alignment

At this point, any Gantry ties or assists may be removed carefully.

Once all assists are removed, check that the camper aligns along the ModCAP base perimeter and that all rubbers are still in place.

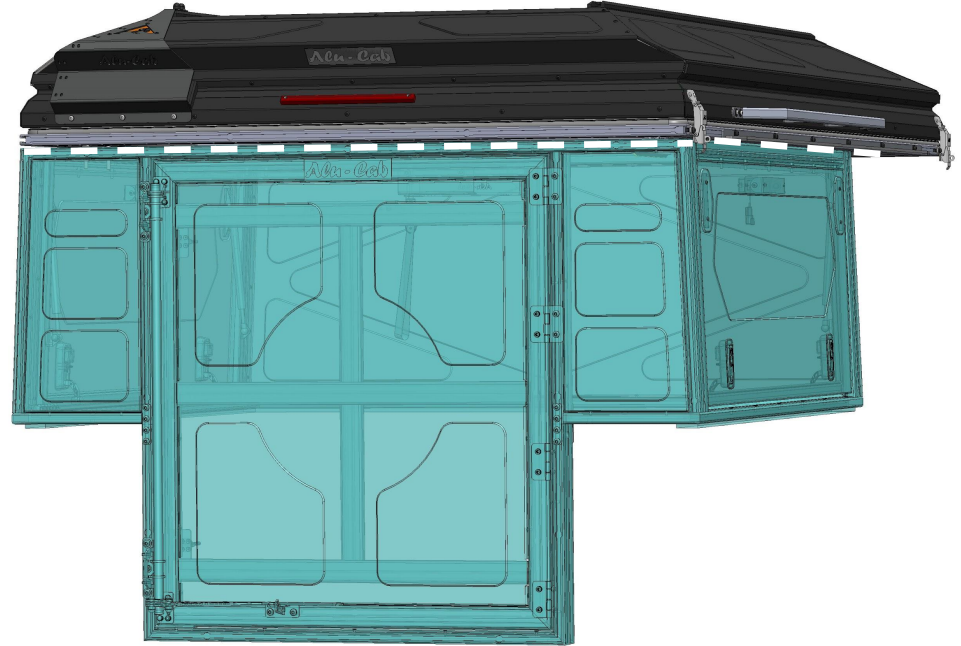

Installation Instructions

ModCAP Family Camper – Tools, Fasteners & Hardware

TMK Rear External Brackets

4

Install the following **Rear Mounting Brackets** at the rear end of the Camper/Base.
If you have rear molle plates installed to the ModCAP Canopy, the Rear Mounting Brackets will slot between them.

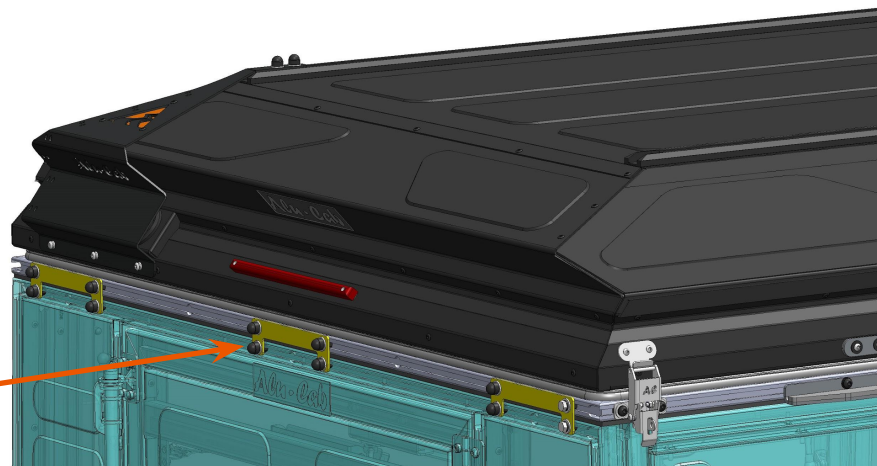
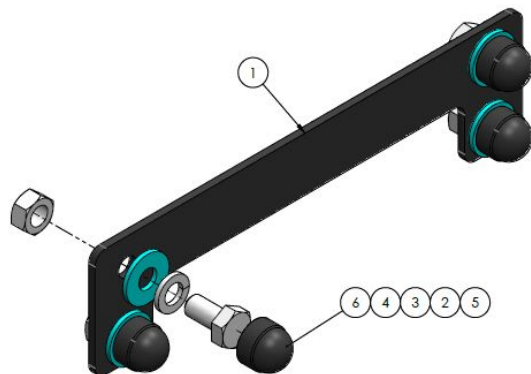

| ITEM NO. | PART NUMBER | DESCRIPTION | QTY |
|----------|---------------------|---|-----|
| 1 | CC2-BO-FAM-TMK-P005 | FAMILY CAMPER REAR MOUNTING BRACKET | 1 |
| 2 | FFW-M8 | M8x20mm OVERSIZED WASHER S/S - DIN 9021 | 4 |
| 3 | SW-M8 | M8 SPRING WASHER S/S | 4 |
| 4 | HEX-M8x16 | M8x16 HEX BOLT S/S | 4 |
| 5 | NUT-M8 | M8 HEX NUT S/S | 4 |
| 6 | NCAP-M8 | NUT CAP-08mm | 4 |

Installation Instructions

ModCAP Family Camper – Tools, Fasteners & Hardware

TMK Internal Bottom Clamping Brackets (Hinge Side)

5 The following internal bottom clamping brackets should be installed at the hinge side of the Camper.

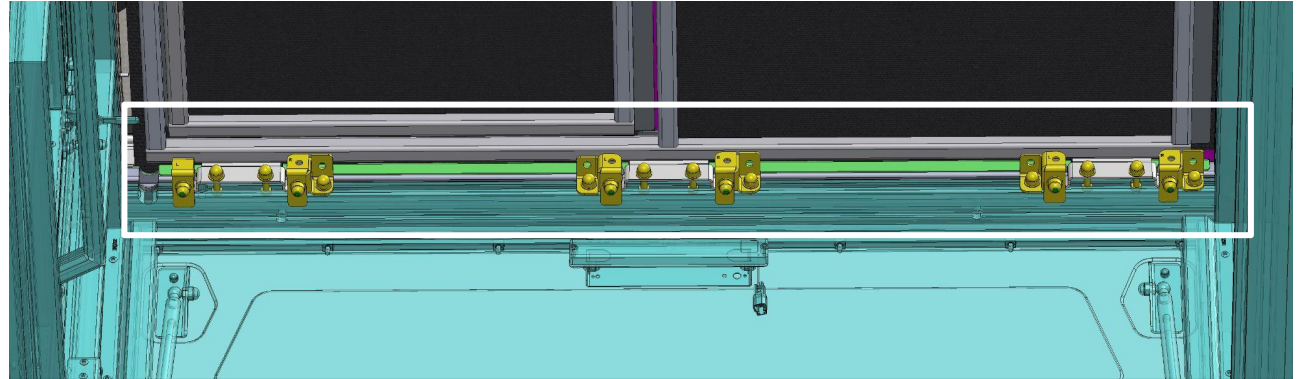

Installation Instructions

ModCAP Family Camper – Tools, Fasteners & Hardware

5.1

TMK Internal Bottom Clamping Brackets (Hinge Side)

The bottom clamping brackets are labelled "L" and "R" to determine left and right sides, match the brackets as shown in the image.

Attach all their respective fasteners as shown.

Assembly A01

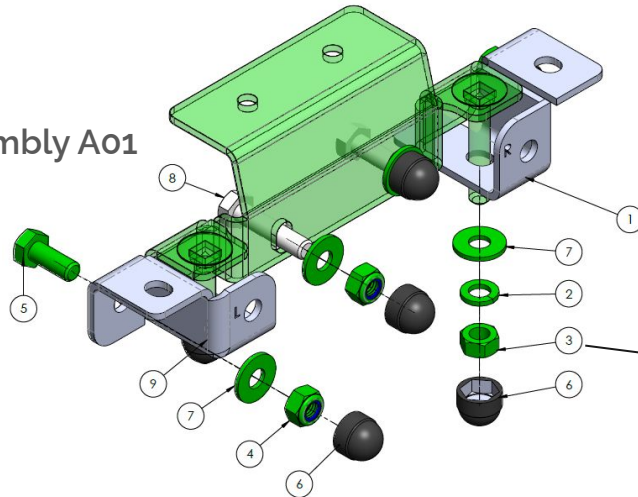

NB. Ensure bolts (Item 3) are fastened to a max of **5 NM** of torque to avoid excessive flange bending.

ASSEMBLY A01 LOCATION (DC, XC, FSS, FSL)

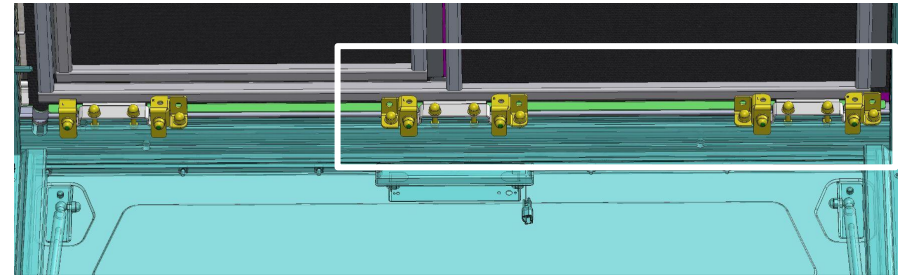

| ITEM NO. | PART NUMBER | DESCRIPTION | QTY |
|----------|---------------------|--|-----|
| 1 | CC2-BO-FAM-TMK-P003 | FAMILY CAMPER BOTTOM CLAMP SUPPORT - RIGHT | 1 |
| 2 | SW-M8 | M8 SPRING WASHER S/S | 2 |
| 3 | NUT-M8 | M8 HEX NUT S/S | 2 |
| 4 | NY-M8 | M8 NYLOC NUT S/S | 4 |
| 5 | HEX-M8x20 | M8x20 HEX BOLT S/S | 2 |
| 6 | NCAP-M8 | NUT CAP-08mm | 6 |
| 7 | FFW-M8 | M8x20mm OVERSIZED WASHER S/S - DIN 9021 | 6 |
| 8 | HEX-M8x35 | M8x35 HEX BOLT S/S | 2 |
| 9 | CC2-BO-FAM-TMK-P015 | FAMILY CAMPER BOTTOM CLAMP SUPPORT - LEFT | 1 |

Installation Instructions

ModCAP Family Camper – Tools, Fasteners & Hardware

TMK Internal Bottom Clamping Brackets (Hinge Side)

5.2

ASSEMBLY A011 LOCATION (DC, XC, FSS, FSL and LCD)

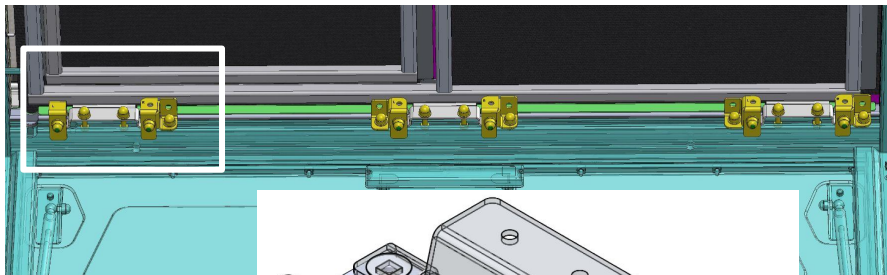

Assembly A011

NB. Ensure bolts (Item 5) are fastened to a max of **5 NM** of torque to avoid excessive flange bending.

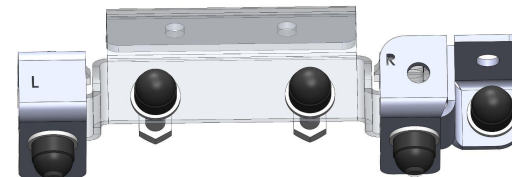
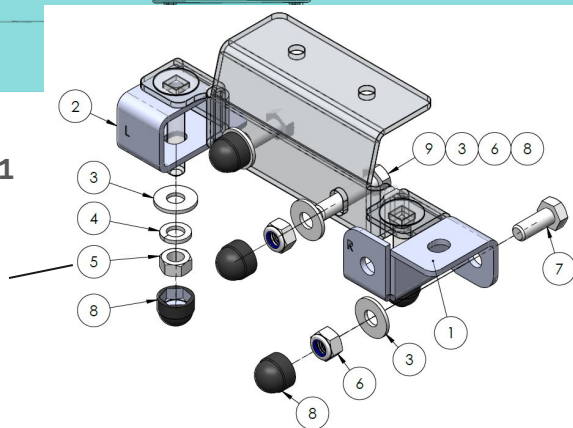

| ITEM NO. | PART NUMBER | DESCRIPTION | QTY |
|----------|---------------------|---|-----|
| 1 | CC2-BO-FAM-TMK-P003 | FAMILY CAMPER BOTTOM CLAMP SUPPORT - RIGHT | 1 |
| 2 | CC2-BO-FAM-TMK-P016 | FAMILY CAMPER BOTTOM CLAMP SUPPORT - CORNER | 1 |
| 3 | FFW-M8 | M8x20mm OVERSIZED WASHER S/S - DIN 9021 | 5 |
| 4 | SW-M8 | M8 SPRING WASHER S/S | 2 |
| 5 | NUT-M8 | M8 HEX NUT S/S | 2 |
| 6 | NY-M8 | M8 NYLOC NUT S/S | 3 |
| 7 | HEX-M8x20 | M8x20 HEX BOLT S/S | 1 |
| 8 | NCAP-M8 | NUT CAP-08mm | 5 |
| 9 | HEX-M8x35 | M8x35 HEX BOLT S/S | 2 |

Installation Instructions

ModCAP Family Camper – Tools, Fasteners & Hardware

TMK Internal Bottom Clamping Brackets (Hinge Side)

5.3

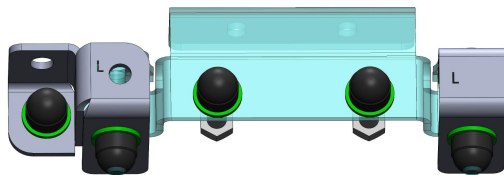

| ITEM NO. | PART NUMBER | DESCRIPTION | QTY |
|----------|---------------------|---|-----|
| 1 | CC2-BO-FAM-TMK-P003 | FAMILY CAMPER BOTTOM CLAMP SUPPORT - RIGHT | 1 |
| 2 | CC2-BO-FAM-TMK-P016 | FAMILY CAMPER BOTTOM CLAMP SUPPORT - CORNER | 1 |
| 3 | FFW-M8 | M8x20mm OVERSIZED WASHER S/S - DIN 9021 | 5 |
| 4 | SW-M8 | M8 SPRING WASHER S/S | 2 |
| 5 | NUT-M8 | M8 HEX NUT S/S | 2 |
| 6 | NY-M8 | M8 NYLOC NUT S/S | 3 |
| 7 | HEX-M8x20 | M8x20 HEX BOLT S/S | 1 |
| 8 | NCAP-M8 | NUT CAP-08mm | 5 |
| 9 | HEX-M8x35 | M8x35 HEX BOLT S/S | 2 |

ASSEMBLY A12 LOCATION (LCD only)

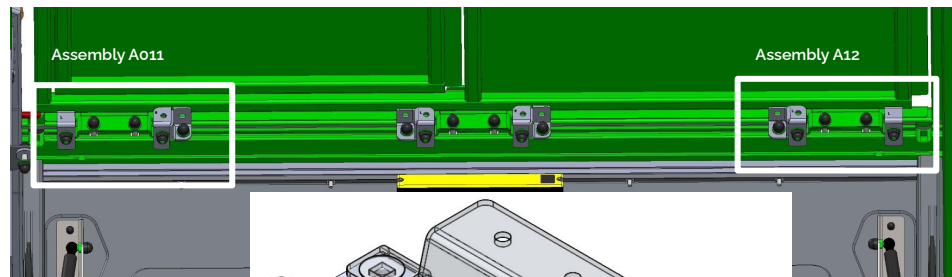

Assembly A12

NB. Ensure bolts (Item 5) are fastened to a max of **5 NM** of torque to avoid excessive flange bending.

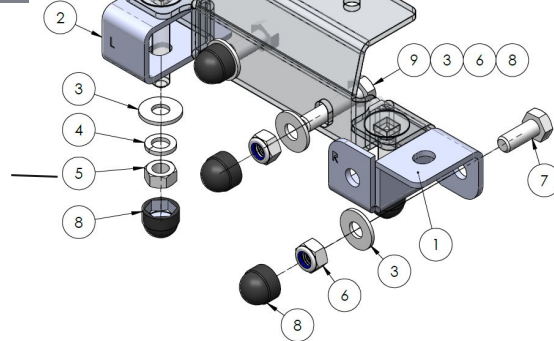

Installation Instructions

ModCAP Family Camper – Tools, Fasteners & Hardware

TMK Internal Clamping Brackets (Opening Side)

6

The following internal clamping brackets should be installed at the flip lid opening side of the Camper.

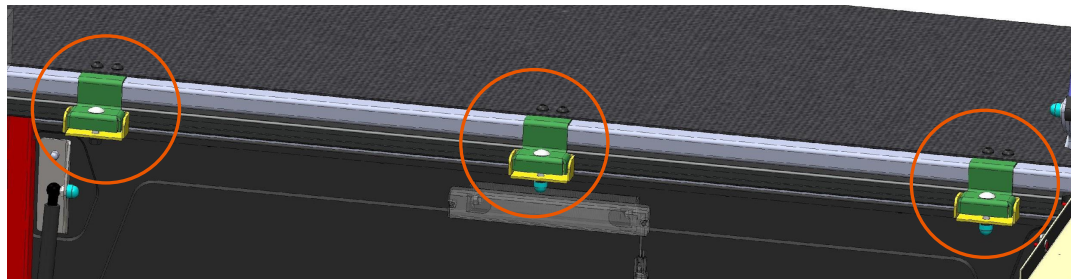
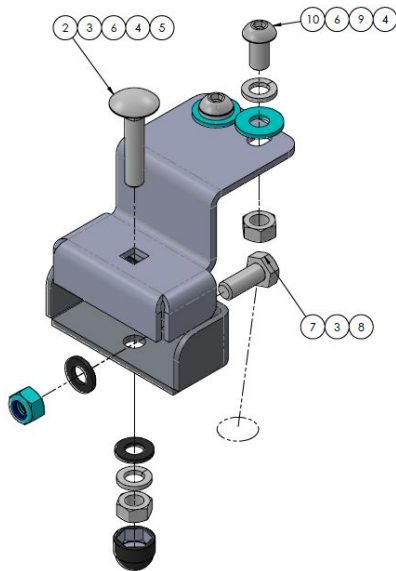

| ITEM NO. | PART NUMBER | DESCRIPTION | QTY |
|----------|---------------------|---|-----|
| 1 | CC2-BO-FAM-TMK-P004 | CAMPER BASE TO TENT TOP CLAMP RHS | 1 |
| 2 | SQN-M8x40 | M8x40 CUP SQ BOLT S/S | 1 |
| 3 | FW-M8 | M8x16mm FLAT WASHER S/S - DIN 125 | 3 |
| 4 | NUT-M8 | M8 HEX NUT S/S | 3 |
| 5 | NCAP-M8 | NUT CAP-08mm | 1 |
| 6 | SW-M8 | M8 SPRING WASHER S/S | 3 |
| 7 | HEX-M8x20 | M8x20 HEX BOLT S/S | 2 |
| 8 | NY-M8 | M8 NYLOC NUT S/S | 2 |
| 9 | FFW-M8 | M8x20mm OVERSIZED WASHER S/S - DIN 9021 | 2 |
| 10 | BHD-M8x16 | M8x16 B/HD BOLT S/S | 2 |
| 11 | CC2-BO-FAM-TMK-P013 | FAMILY CAMPER BOTTOM CLAMP SUPPORT 2 | 1 |

Installation Instructions

ModCAP Family Camper – Tools, Fasteners & Hardware

TMK Internal Bottom Clamping Brackets (Opening Side)

6.1

At the flip lid opening side of the Camper, Slide x6 M8x16 HEX bolts in the loadbar's side nut slots as shown.

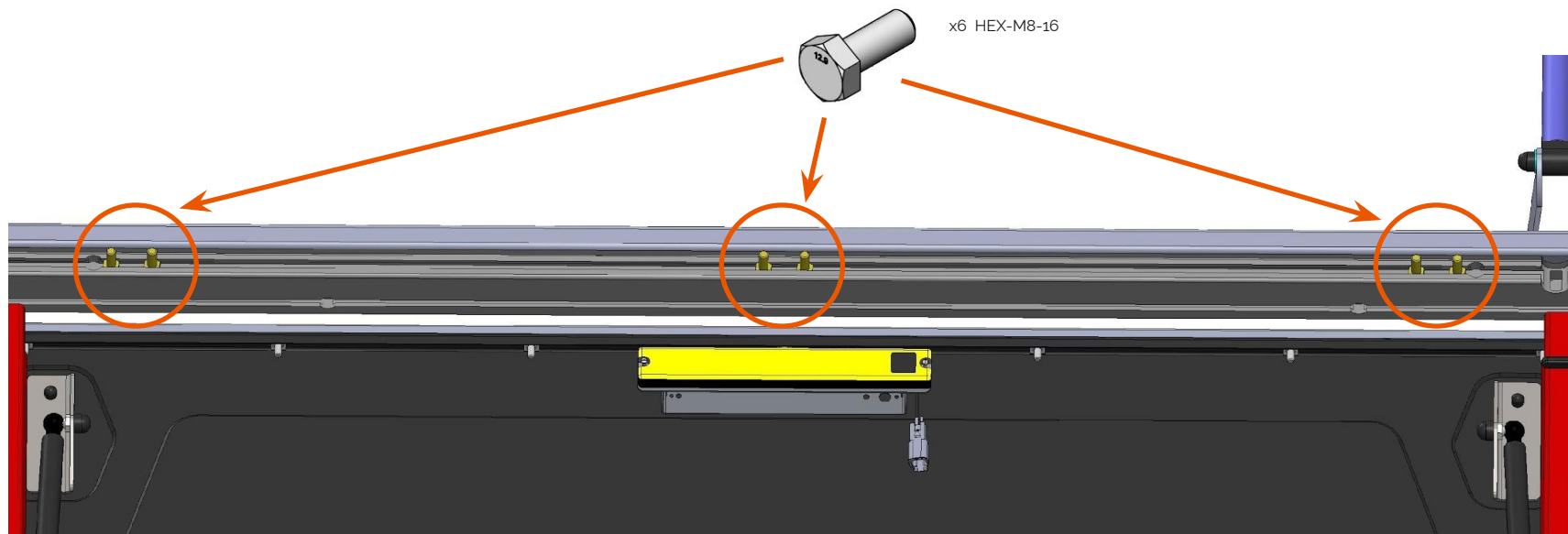

Installation Instructions

ModCAP Family Camper – Tools, Fasteners & Hardware

TMK Internal Bottom Clamping Brackets (Opening Side)

6.2

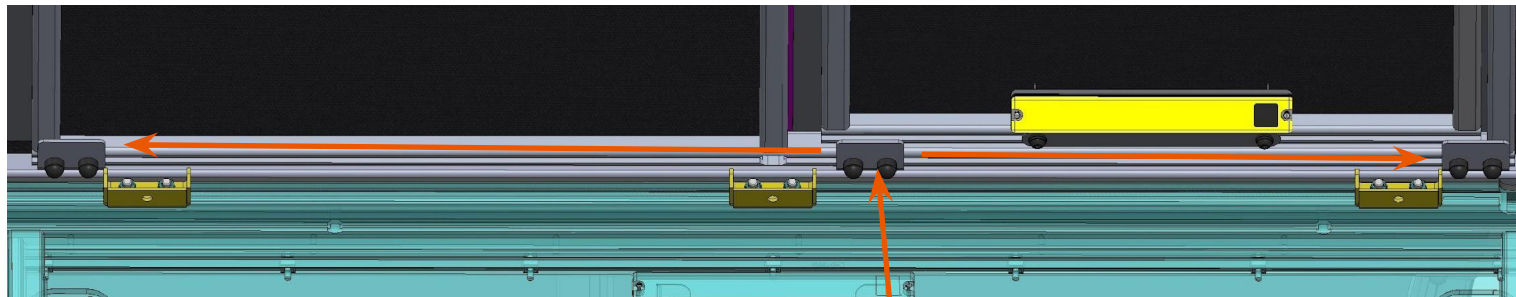

The **bottom clamping bracket** (Highlighted **yellow**) should be installed next to the **bed section stopper brackets**. See above diagram and match positions.

Installation Instructions

ModCAP Family Camper – Tools, Fasteners & Hardware

TMK Internal Bottom Clamping Brackets (Opening Side)

6.3

Fasten all 3 brackets securely with an M8-Washer and M8 Nyloc Nut.



x6 FW-M8



x6 M8 Nyloc

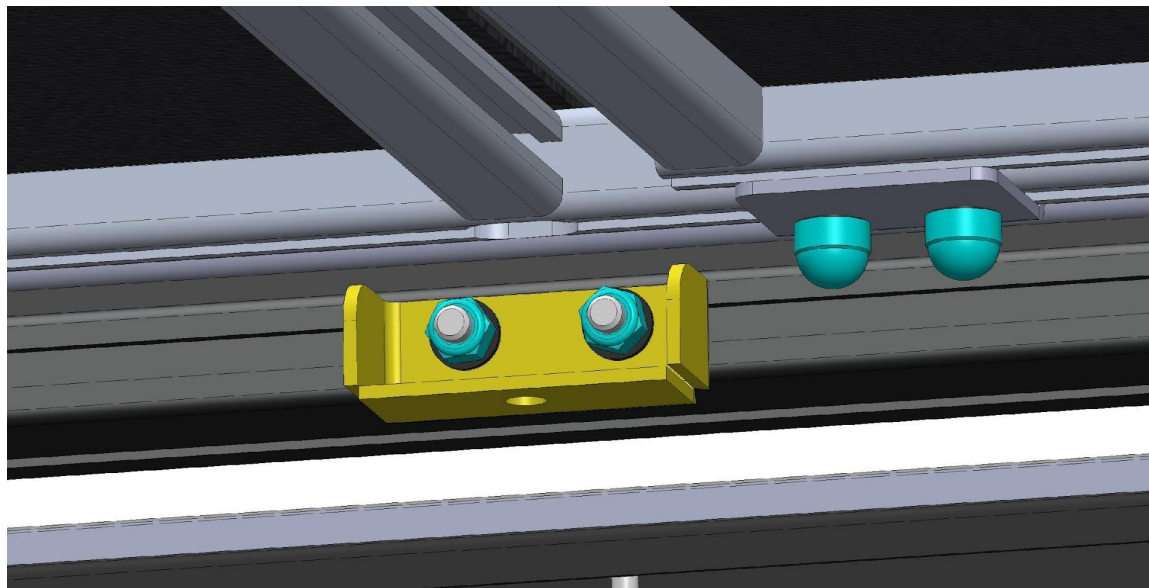

Installation Instructions

ModCAP Family Camper – Tools, Fasteners & Hardware

TMK Internal Bottom Clamping Brackets (Opening Side)

6.4

The Camper will need to be opened in order to install the following top clamping brackets

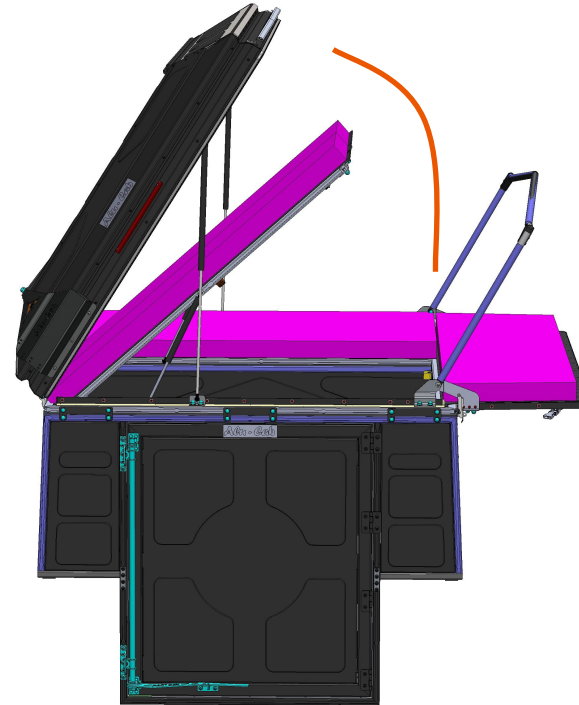

Installation Instructions

ModCAP Family Camper – Tools, Fasteners & Hardware

6.5

TMK Internal Bottom Clamping Brackets (Opening Side)

At the flip lid area, do the following:

- I. Lift carpet.
- II. Lift crad rubber out the nut slot.
- III. Ready for top clamp installation.

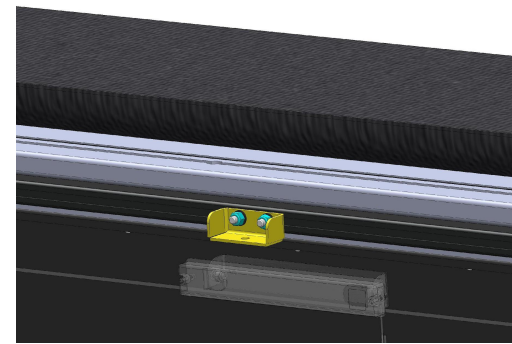
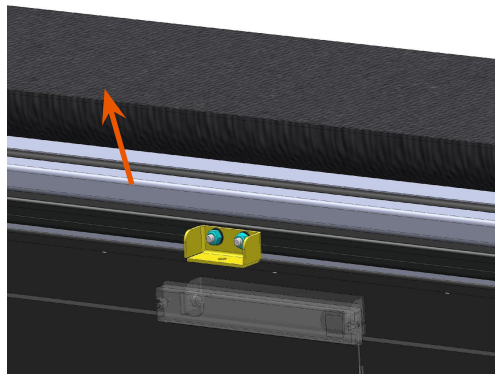
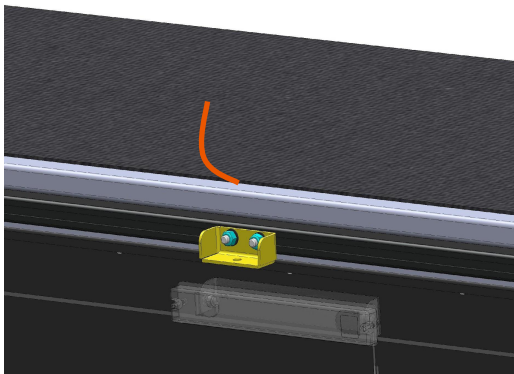

Installation Instructions

ModCAP Family Camper – Tools, Fasteners & Hardware

6.6

TMK Internal Bottom Clamping Brackets (Opening Side)

Slide x6 M8-NUT into the nutslot, align them to the bottom clamps as shown below.



x6 NUT-M8

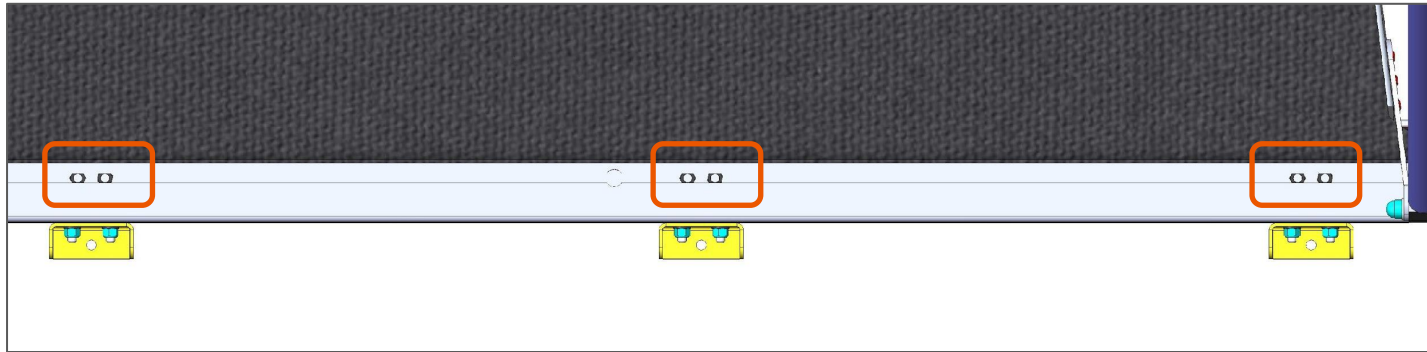

Installation Instructions

ModCAP Family Camper – Tools, Fasteners & Hardware

TMK Internal Bottom Clamping Brackets (Opening Side)

6.7

Use the supplied BHD M8x16 bolts and FFW M8 washers to fasten down the 3 Top Clamps.

Use the following fasteners to clamp down the 2 brackets.

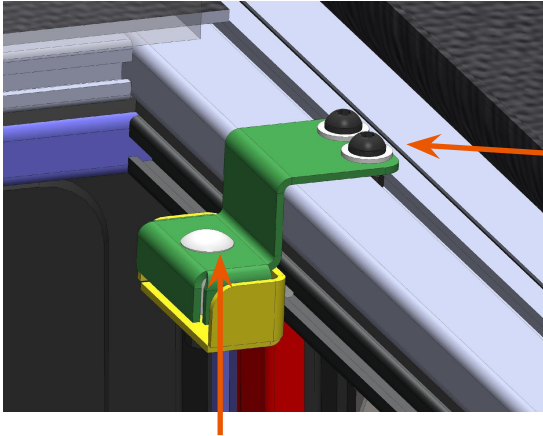

Slot in the M8x40 cup squares.

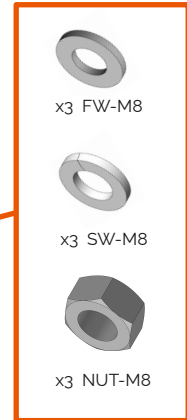
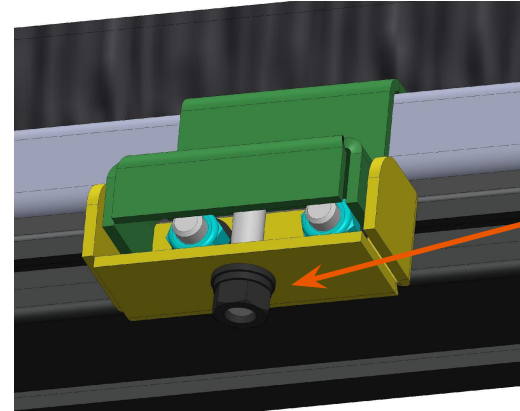
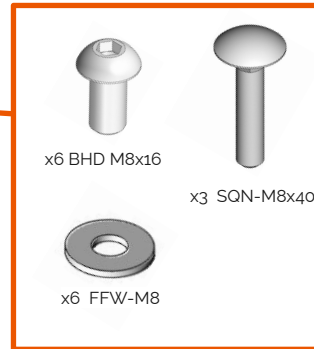

NOTE: The SQN-M8x40 bolts may at first seem to not reach the bottom clamp hole. In that case, a **clamp** can be used to squeeze the Camper and the base down first, and then fastening down the SQN-M8x40 bolt. The rest should then follow along.

Installation Instructions

ModCAP Family Camper – Tools, Fasteners & Hardware

TMK Internal Bottom Clamping Brackets (Opening Side)

6.8

The crad rubber can be re-inserted into the nut slot. The crad rubber will need to be cut apart and spaced accordingly - see image below.

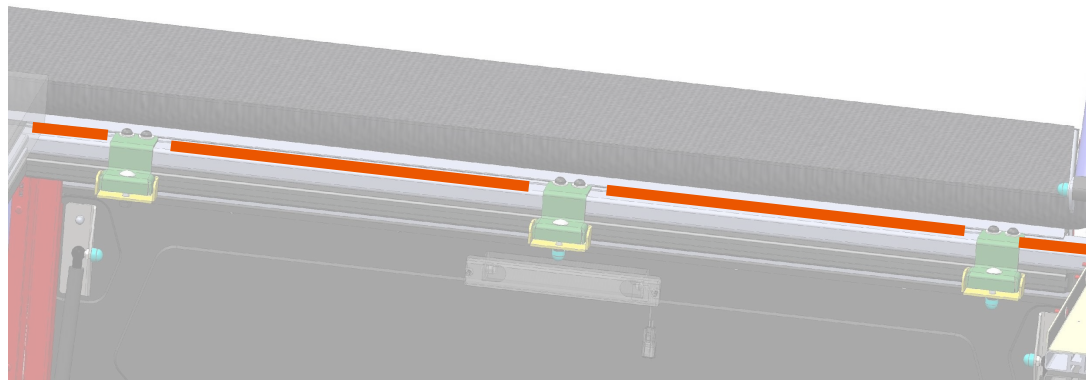

The carpet can then be dropped once the clamps are completely installed.

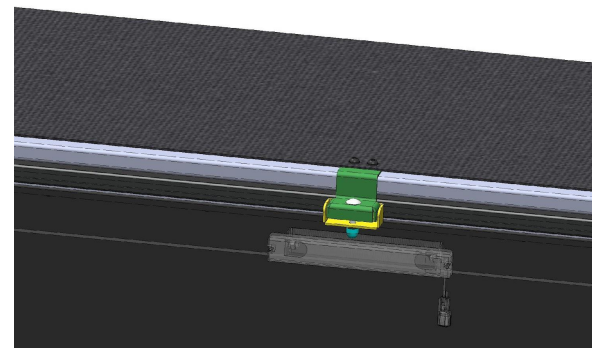

Installation Instructions

ModCAP Family Camper – Tools, Fasteners & Hardware

TMK - Front Mounting Supports (Centre)

7

The following front mounting supports will be installed at the front centre of the Family Camper.
Slide the appropriate Hex bolts into the nut slots and fasten down as shown in the assembly.

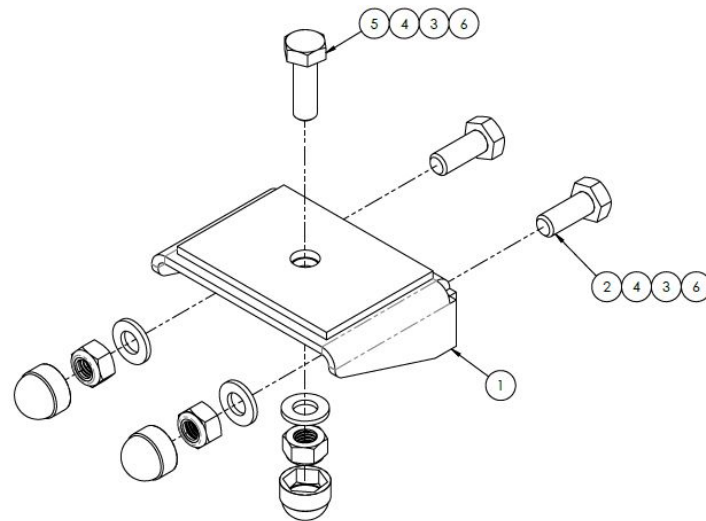
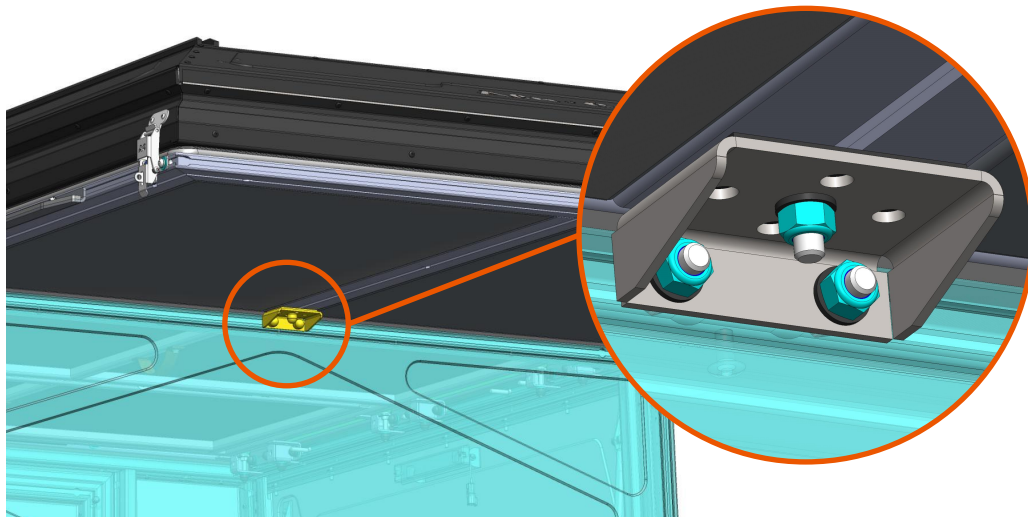

| ITEM NO. | PART NUMBER | DESCRIPTION | QTY |
|----------|-----------------------|-----------------------------------|-----|
| 1 | AC001-CAN-MNT-BRKT-01 | CANOPY MOUNTING BRACKET | 1 |
| 2 | HEX-M8x20 | M8x20 HEX BOLT S/S | 2 |
| 3 | NY-M8 | M8 NYLOC NUT S/S | 3 |
| 4 | FW-M8 | M8x16mm FLAT WASHER S/S - DIN 125 | 3 |
| 5 | HEX-M8x25 | M8x25 HEX BOLT S/S | 1 |
| 6 | NCAP-M8 | NUT CAP-08mm | 3 |

Installation Instructions

ModCAP Family Camper – Tools, Fasteners & Hardware

8

TMK - Front Mounting Supports (Sides)

The following overhang bracket will be assembled at the front of the Camper.

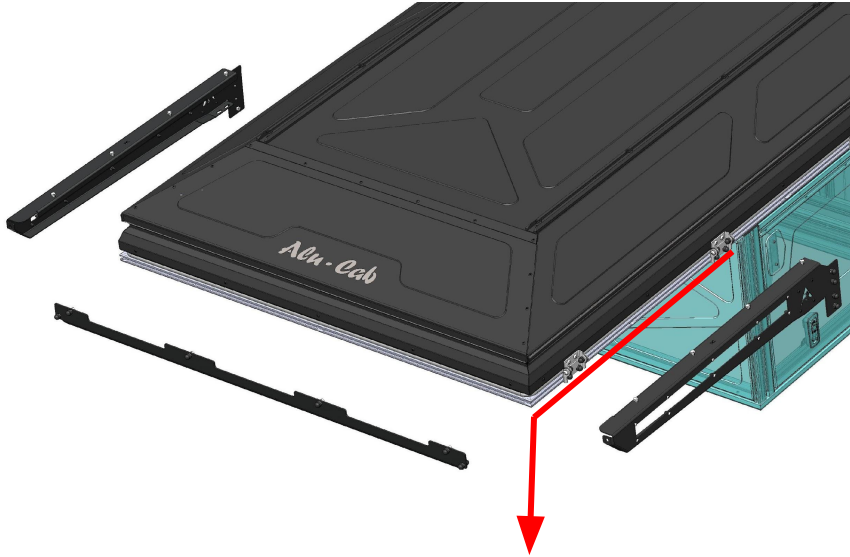

It is important to hold the overhang straight (avoid the bowing effect) when installing the front mounting brackets.

DC , DC-HP & LCD

| ITEM NO. | PART NUMBER | DESCRIPTION | QTY |
|----------|-------------|-----------------------------------|-----|
| 1 | HEX-M8x20 | M8x20 HEX BOLT S/S | 19 |
| 2 | FW-M8 | M8x16mm FLAT WASHER S/S - DIN 125 | 21 |
| 3 | NY-M8 | M8 NYLOC NUT S/S | 19 |
| 4 | NCAP-M8 | NUT CAP-08mm | 21 |

FSS, FSL & XC

| ITEM NO. | PART NUMBER | DESCRIPTION | QTY |
|----------|-------------|-----------------------------------|-----|
| 1 | HEX-M8x20 | M8x20 HEX BOLT S/S | 17 |
| 2 | FW-M8 | M8x16mm FLAT WASHER S/S - DIN 125 | 21 |
| 3 | NY-M8 | M8 NYLOC NUT S/S | 17 |
| 4 | NCAP-M8 | NUT CAP-08mm | 21 |

Installation Instructions

ModCAP Family Camper – Tools, Fasteners & Hardware

8.1

TMK - Front Mounting Supports (Sides) - LEFT AND RIGHT

Slide the appropriate Hex bolts into the nut slots and fasten down as shown in the assembly. Do this for both **left** and right **supports**

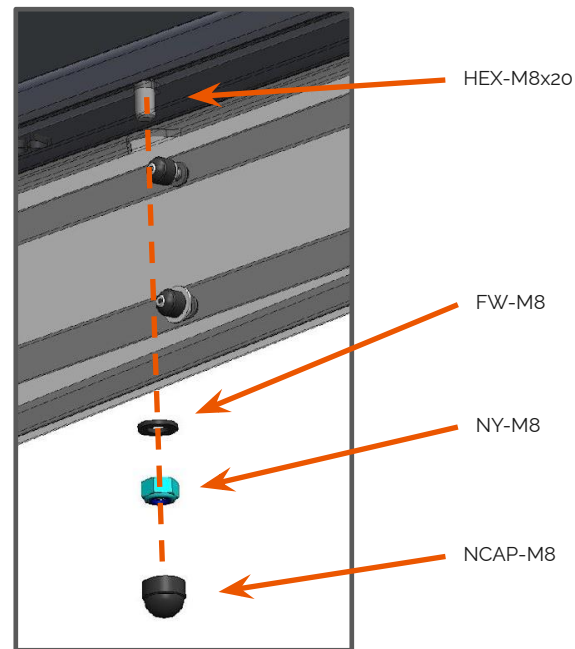
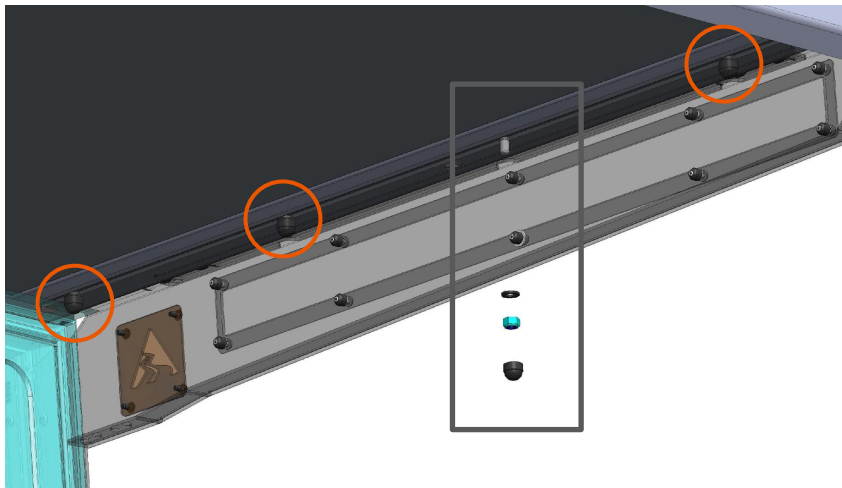

Installation Instructions

ModCAP Family Camper – Tools, Fasteners & Hardware

TMK - Front Mounting Supports (Sides) - LEFT

8.2

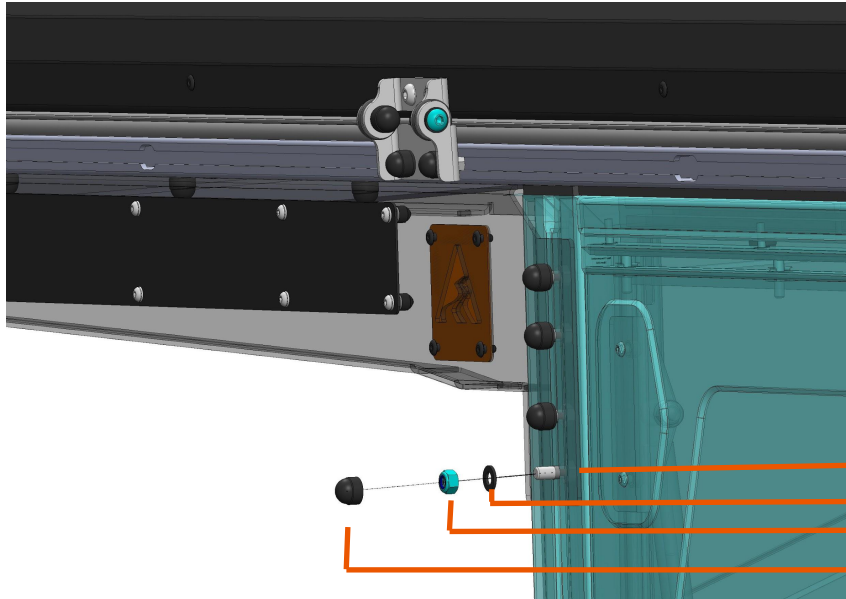

For the left hand side (Situating by the main lid hinges) Slide x4 M8x20 Hex bolts into the ModCAP base to fasten the side supports down as shown in the image.

HEX-M8x20

FW-M8

NY-M8

NCAP-M8

Installation Instructions

ModCAP Family Camper – Tools, Fasteners & Hardware

8.3

TMK - Front Mounting Supports (Sides) - RIGHT [DC/XC SPECIFIC]

The following **Family Camper Pipe Support** should be installed on the right side (The Family Camper handle side). The first 3 holes will match up with the side support holes.

Slide x3 M8x20 Hex bolts into the ModCAP base to fasten the side supports down together with the Pipe support. There should be x1 M8x20 Bolt fastened at the end.



Family Camper Pipe Support

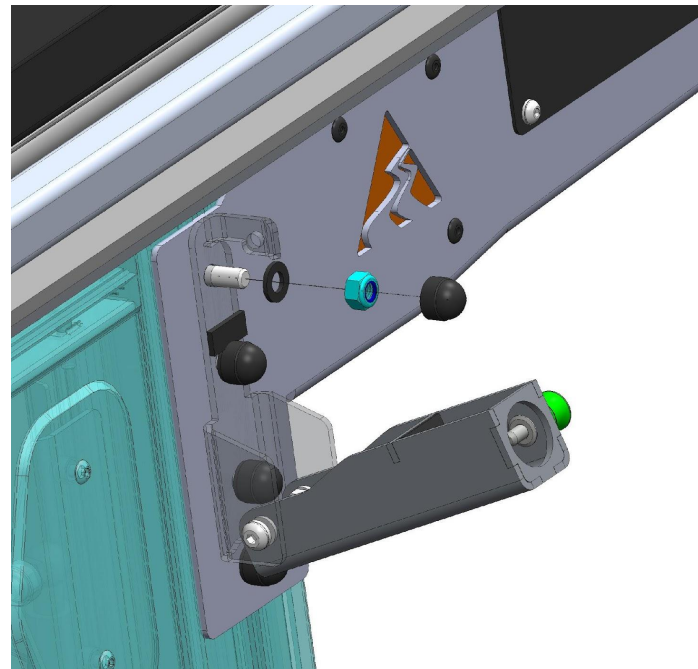
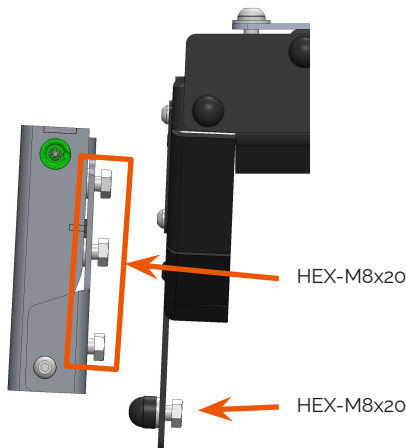

Installation Instructions

ModCAP Family Camper – Tools, Fasteners & Hardware

8.4

TMK - Front Mounting Supports (Sides) - RIGHT [FSS/FSL and LCD SPECIFIC]

The following images shows the positions for FSS/FSL and LCD bases in relation to their side supports.

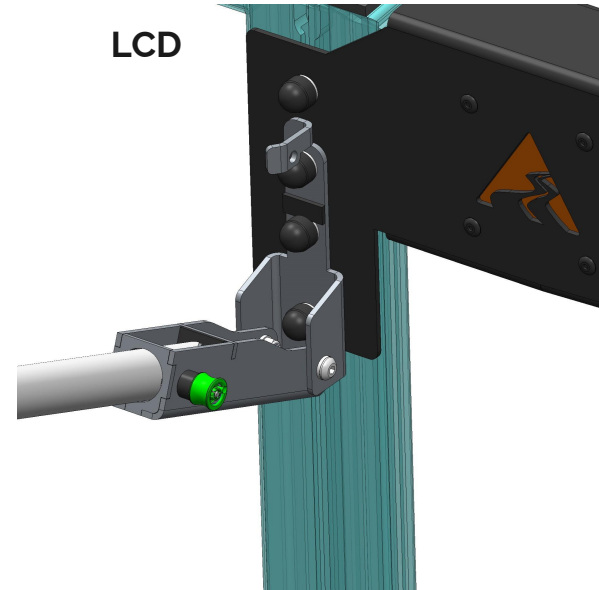
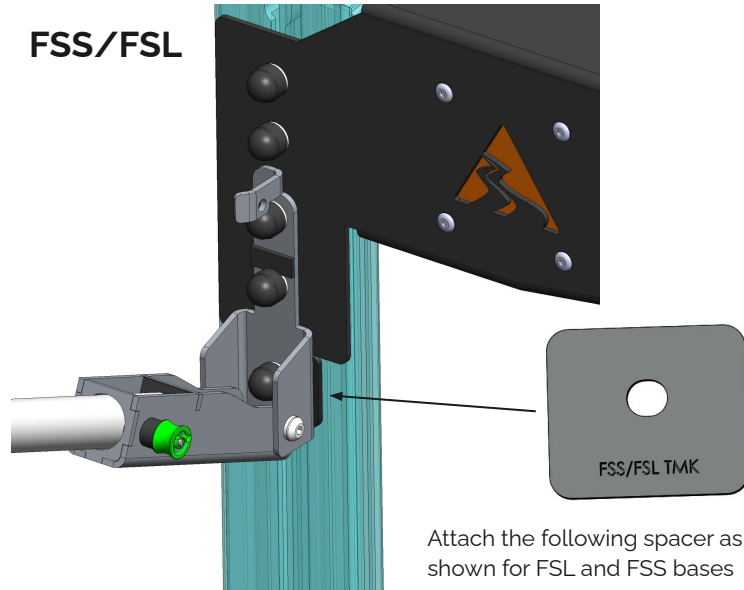

Installation Instructions

ModCAP Family Camper – Tools, Fasteners & Hardware

TMK - Family Bed Support

9

The following **Family Bed Support** should be installed on the flip out bed at the underside.

NB. it is important to line it up along the **Pipe support** as the 2 assemblies work together.

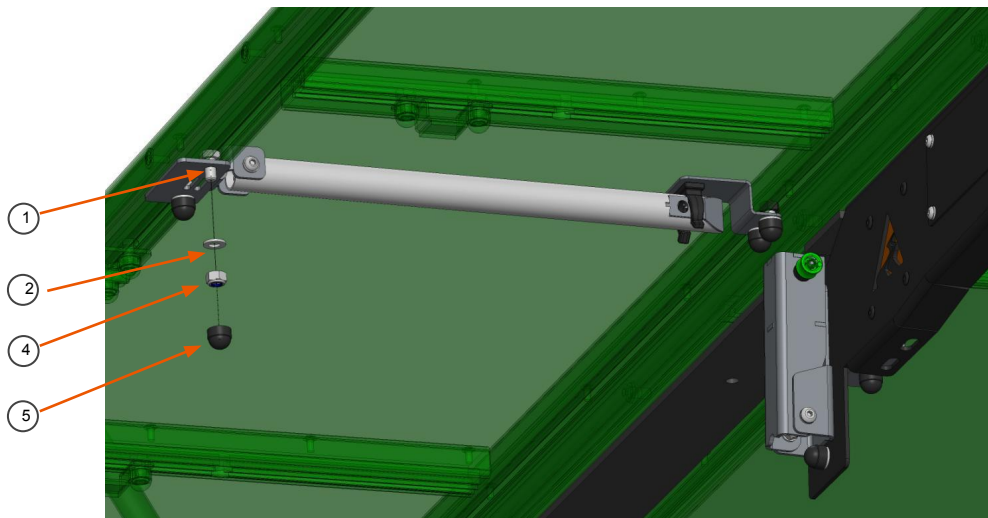

| ITEM NO. | PART NUMBER | DESCRIPTION | QTY |
|----------|-------------|-----------------------------------|-----|
| 1 | NUT-M8 | M8 HEX NUT S/S | 2 |
| 2 | FW-M8 | M8x16mm FLAT WASHER S/S - DIN 125 | 4 |
| 3 | HEX-M8x16 | M8x16 HEX BOLT S/S | 4 |
| 4 | NY-M8 | M8 NYLOC NUT S/S | 2 |
| 5 | NCAP-M8 | NUT CAP-08mm | 4 |

Installation Instructions

ModCAP Family Camper – Tools, Fasteners & Hardware

TMK - Family Bed Support & Pipe Support for other bases

10

The following bases will each have x2 **Family Camper Pipe Support** and **Family Bed Support** assemblies to install.

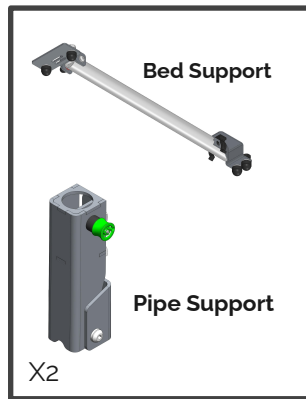
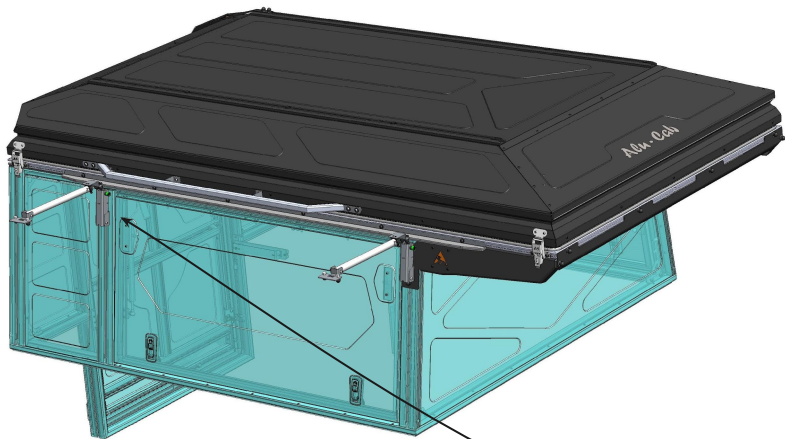

The listed bases that require x2 of the following supports are:

- 1) FSL - Full Size long
- 2) FSS - Full Size short
- 3) XC - Extra cab

NB. The 2nd Pipe Support may be adjusted to fit. Best way to do so is by first installing the **Bed support** and checking to see where the pole stops inside the **Pipe Support**.

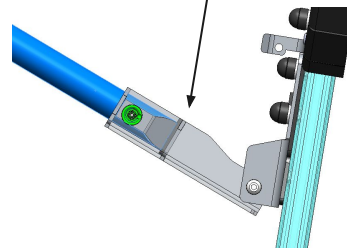

Installation Instructions

ModCAP Family Camper – Tools, Fasteners & Hardware

TMK - Handlebar

11

The following handlebar may be attached on the right hand side below the bed support at any suitable height desired.

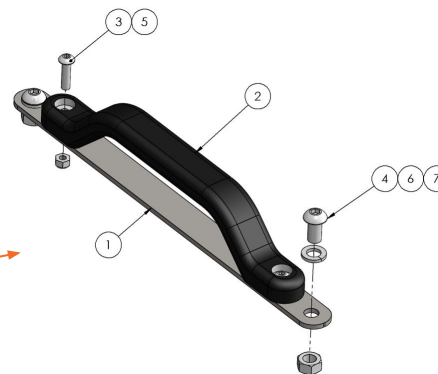

| ITEM NO. | PART NUMBER | DESCRIPTION | QTY |
|----------|-----------------------|----------------------|-----|
| 1 | AC001-HND-ADPT-PLT-01 | HANDLE BACKING PLATE | 1 |
| 2 | GRB-HNDL | BLACK GRAB HANDLE | 1 |
| 3 | BHD-M5x20 | M5x20 B/HD BOLT S/S | 2 |
| 4 | BHD-M8x16 | M8x16 B/HD BOLT S/S | 2 |
| 5 | NY-M5 | M5 NYLOC NUT S/S | 2 |
| 6 | SW-M8 | M8 SPRING WASHER S/S | 2 |
| 7 | NUT-M8 | M8 HEX NUT S/S | 2 |

Installation Instructions

ModCAP Family Camper – Tools, Fasteners & Hardware

12

Completed Installation

The Family Camper should now be completely installed to the chosen ModCAP Canopy.



Disclaimer

All rights reserved. No part of this website may be reproduced, translated, stored in a retrieval system, or transmitted, in any form or by any means, electronic, mechanical, photocopying, recording or otherwise, without prior written permission of the owner.

Review all instructions information carefully before installation.

Any damages, direct or incidental to the installer and/or property due to incorrect installation of any parts are the responsibility of the installer. Due to the various applications and fitment options available, the responsibility lies with the user to ensure all mounting points are secure and tight before every trip.

If unsure, consult with your Distributor regarding the operations of our products.

Users are advised to be mindful of the load they are carrying and drive in accordance with road conditions.

WARNING

Always wear appropriate PPE (Personal protection equipment) when fitting our products. Although the mounting kit is designed to be DIY, if you have any doubts or concerns, contact an accredited fitment centre to carry out the work. Alu-Cab will not be liable for any injury to persons, and/or damage to products and/or vehicles.

While Alu-Cab Holdings takes reasonable measures to ensure that the contents of this Website are accurate and complete, Alu-Cab Holdings makes no representations or warranties, whether express or implied, as to the quality, timeliness, operation, integrity, availability or functionality of this Website or as to the accuracy, completeness or reliability of any information on this Website. Alu-Cab Holdings reserves the right to make changes, corrections and/or improvements to the information and to the products and programs described in such information, at any time without notice.

Alu-Cab Holdings will use reasonable endeavours to maintain the availability of the Website, except during scheduled maintenance periods, and reserves the right to discontinue providing the Website or the service or any part thereof with or without notice to you. Any person who accesses this Website or relies on this Website or on the information contained in this Website does so at his or her own risk.

Occasionally, at our discretion, we may include or offer third-party products or services on our website. These third-party sites have separate and independent privacy policies. We therefore have no responsibility or liability for the content and activities of these linked sites. Nonetheless, we seek to protect the integrity of our site and welcome any feedback about these sites.