



FITMENT INSTRUCTIONS

Nissan Frontier 2022+ Canopy Camper Double Cab

Installation Instructions

Preliminary information

Installation and fitment instructions includes the tools required, fasteners included in the kit, and the hardware included in the kit.

Please follow the instructions and check installation steps with the images in this document.

Alu-Cab recommends that all sealing work is allowed to cure for 24 hours, after which you may drive the vehicle on normal paved roads. Before driving off-road with your Alu-Cab product or operating your roof conversion, an additional cure period of 48 hours is required.

Failure to follow these instructions will void your warranty. Please ensure that you follow the sealant manufacturers curing time as per their technical data sheet.

These times may differ slightly from the times we have recommended.



Service Enquiries email
queries@alu-cab.com

Mouting Instructions

Please note, our mounting brackets and hardware for campers and canopies, are designed to be mounted directly to the loadbody, and not through a plastic loadbin liner.

Failure to remove or provide adequate clearance by way of cutting/modifying the liner to allow direct mounting to the load body, will result in an inferior installation that will void all warranties.



Installation Instructions

Canopy Camper Fitment – Tools, Fasteners & Hardware

1.1

Tools & Items Required

| |
|--------------------------|
| 13mm Ring Spanner/Socket |
|--------------------------|

| |
|---------|
| Ratchet |
|---------|

1.3

Items

| |
|------------|
| Turpentine |
|------------|

| |
|-------|
| Cloth |
|-------|

| |
|-------------------------------------|
| Black sealant, silicone or Sikaflex |
|-------------------------------------|

| |
|----------------|
| Window Cleaner |
|----------------|

1.2

Fasteners Supplied (included with Filler Kit)

| | |
|--------------------|----|
| M8x20 HEX BOLT S/S | 26 |
|--------------------|----|

| | |
|-----------------------------------|----|
| M8x16mm FLAT WASHER S/S - DIN 125 | 32 |
|-----------------------------------|----|

| | |
|-----------|----|
| NCAP-o8mm | 56 |
|-----------|----|

| | |
|------------------|----|
| M8 NYLOC NUT S/S | 50 |
|------------------|----|

| | |
|---|----|
| M8x20mm OVERSIZED WASHER S/S - DIN 9021 | 24 |
|---|----|

| | |
|-------------------|---|
| ELASTIC BAND NO.6 | 6 |
|-------------------|---|

| | |
|-----------------------|----|
| M8x30 CUP SQ BOLT S/S | 12 |
|-----------------------|----|

| | |
|--------------------|----|
| M8x25 HEX BOLT S/S | 12 |
|--------------------|----|

Installation Instructions

Canopy Camper Fitment – Tools, Fasteners & Hardware

1.4

Sheet Metal Part Identification:

Rear Filler

| Part Number | Description | Qty |
|-----------------|--|-----|
| CC-FK-NF22-P001 | NISSAN FRONTIER 2022+ REAR FILLER LHS BOX | 1 |
| CC-FK-NF22-P002 | NISSAN FRONTIER 2022+ REAR FILLER RHS BOX | 1 |
| CC-FK-NF22-P003 | NISSAN FRONTIER 2022+ REAR FILLER BASE PANEL | 1 |

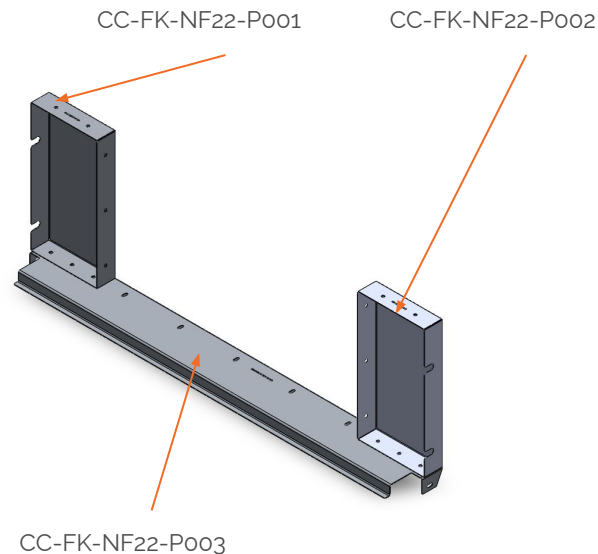

Installation Instructions

Canopy Camper Fitment – Tools, Fasteners & Hardware

1.4

Sheet Metal Part Identification:

Front Filler

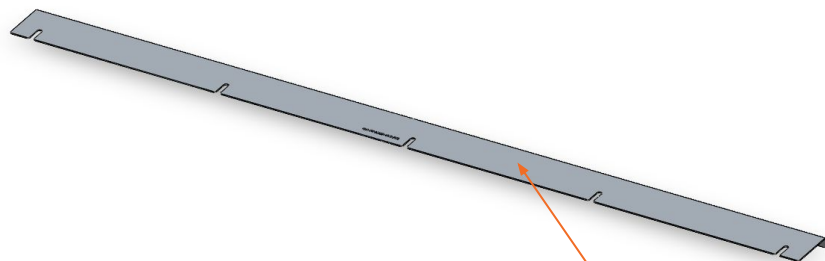

CC-FK-NF22-P004

| Part Number | Description | Qty |
|-----------------|------------------------------------|-----|
| CC-FK-NF22-P004 | NISSAN FRONTIER 2022+ FRONT FILLER | 1 |

Installation Instructions

Canopy Camper Fitment – Tools, Fasteners & Hardware

1.4

Sheet Metal Part Identification:
Mounting Brackets

| Part Number | Description | Qty |
|-----------------|--------------------------------------|-----|
| CC-FK-NF22-P005 | NISSAN FRONTIER 2022+ MOUNTING PLATE | 6 |
| CS-NUT-PLT-01 | CUP SQUARE PLATE | 6 |



CC-FK-NF22-P005

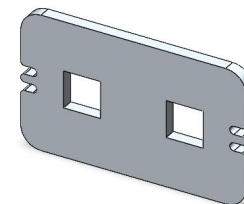

CS-NUT-PLT-01

Installation Instructions

2

Remove Tailgate:

The first step of the Canopy Camper installation process is removing the existing OEM tailgate.

Follow the instructions here [Nissan Frontier 2022 Tailgate Removal](#), page 3-28

Ensure that all the bolts indicated with orange circles are removed from the loadbin. The bolts indicated in green are for the taillights and will remain in position. The filler kit has been designed to fit around these bolts to allow the replacement of any taillight bulbs when necessary.

NOTE: There is a pair of bolts that are indicated as RED, these will be reused during the installation so please do not dispose of them.



Installation Instructions

3

Rear Filler Panel Assembly:

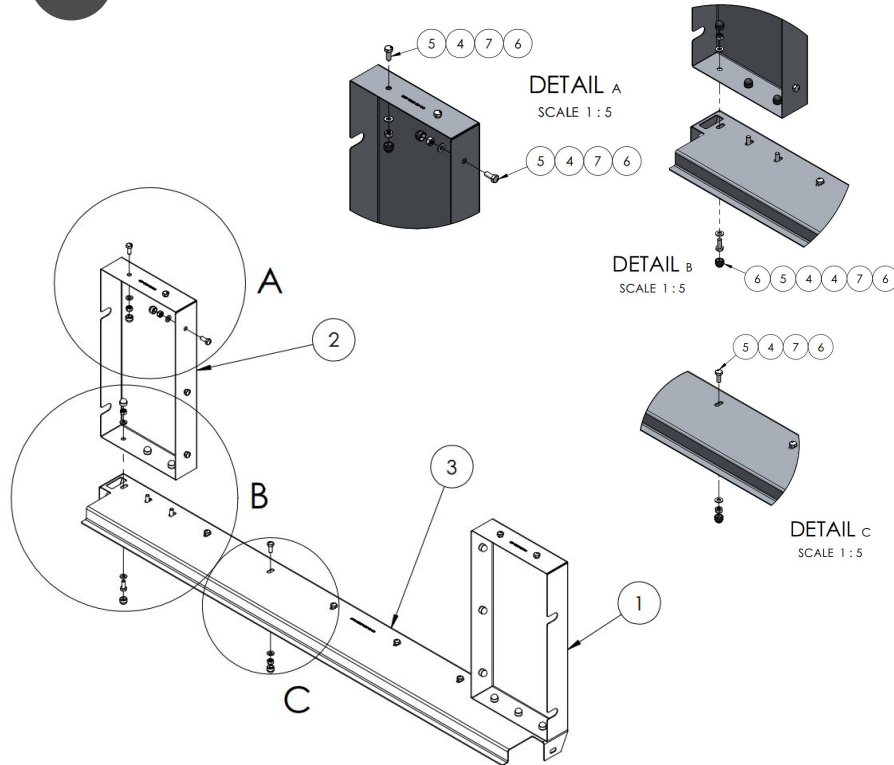

| Item Number | Part Number | Description | Qty |
|-------------|-----------------|--|-----|
| 1 | CC-FK-NF22-P001 | NISSAN FRONTIER 2022+ REAR FILLER LHS BOX | 1 |
| 2 | CC-FK-NF22-P002 | NISSAN FRONTIER 2022+ REAR FILLER RHS BOX | 1 |
| 3 | CC-FK-NF22-P003 | NISSAN FRONTIER 2022+ REAR FILLER BASE PANEL | 1 |
| 4 | FW-M8 | M8x16mm FLAT WASHER S/S - DIN 125 | 27 |
| 5 | HEX-M8x20 | M8x20 HEX BOLT S/S | 21 |
| 6 | NCAP-M8 | NUT CAP-ø8mm | 27 |
| 7 | NY-M8 | M8 NYLOC NUT S/S | 21 |

Installation Instructions

3

Rear Filler Panel Assembly:

1. Attach the NISSAN FRONTIER 2022+ REAR FILLER BASE PANEL to the vehicle using the bolts that you kept separate (marked in red in previous slide).
2. Slide 3 M8x20 Hex Head Bolts into each vertical part of the lower door frame, repeat on LHS and RHS.

3.1

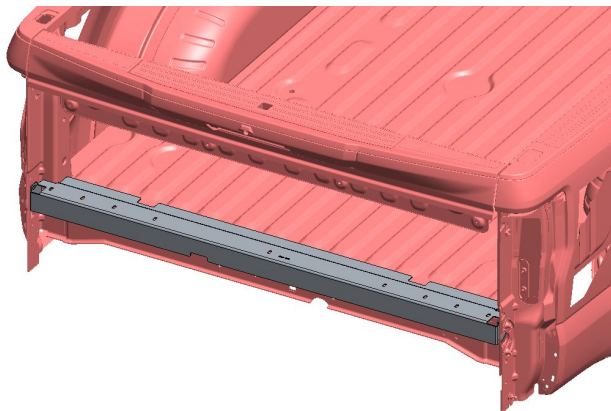

3.2

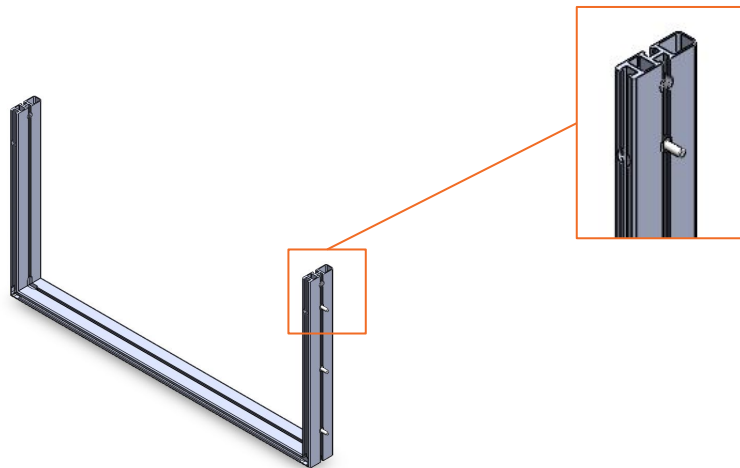

Installation Instructions

3

Rear Filler Panel Assembly:

3. Slide 3 off M8x20 bolts into the bottom channel of the lower door frame.
4. Fit the REAR FILLER RHS & LHS INNER BOXES to the lower door frame by lining up the bolts in the lower door frame with the cutouts on the boxes. Fasten the inner boxes to the lower door frame using the supplied M8 flat washer, Nylock nut and nut cap.

3.3



3.4

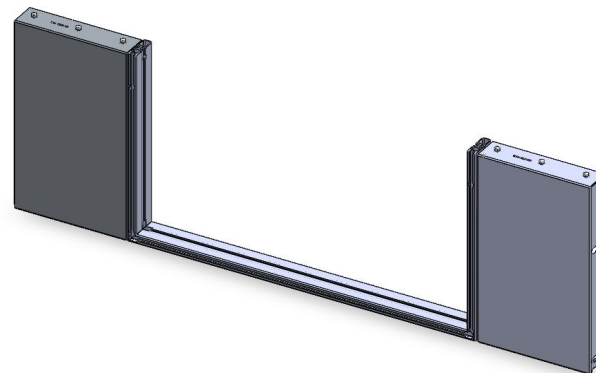

Installation Instructions

3

Rear Filler Panel Assembly:

5. Fit lower door frame and INNER BOXES to REAR FILLER BOTTOM SUPPORT BRACKET, use the supplied M8x20 hex head bolts, flat washers, nylock nuts and nut caps to secure the lower door frame in place.

3.5

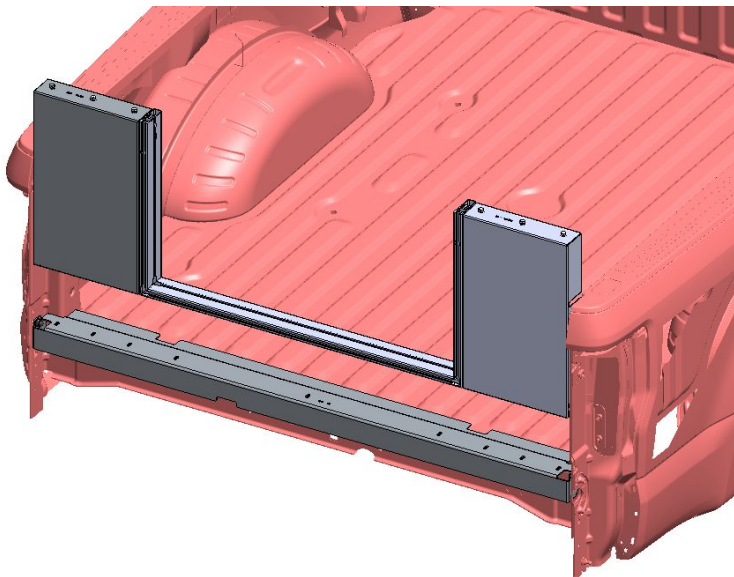

Installation Instructions

4

Front Filler Assembly:

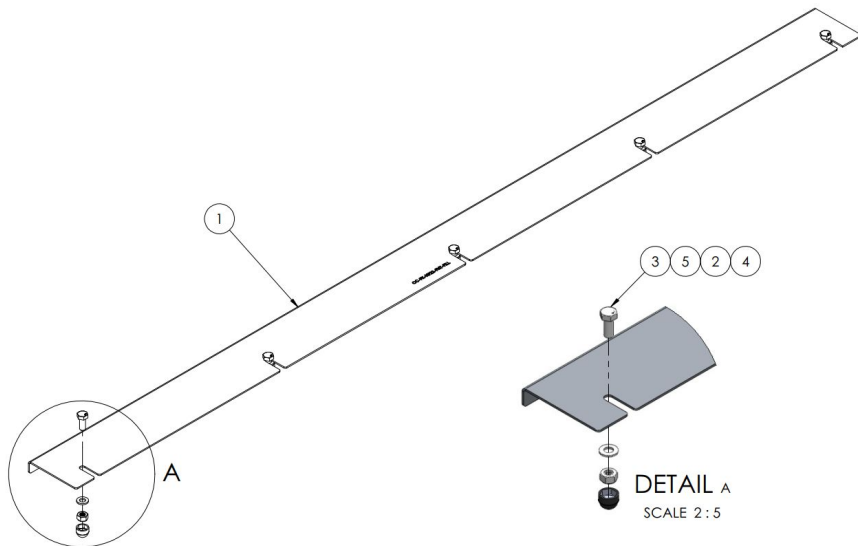

| Item No. | Part Number | Description | Qty |
|----------|-----------------|------------------------------------|-----|
| 1 | CC-FK-NF22-P004 | NISSAN FRONTIER 2022+ FRONT FILLER | 1 |
| 2 | NY-M8 | M8 NYLOC NUT S/S | 5 |
| 3 | HEX-M8x20 | M8x20 HEX BOLT S/S | 5 |
| 4 | NCAP-M8 | NUT CAP-ø8mm | 5 |
| 5 | FW-M8 | M8x16mm FLAT WASHER S/S - DIN 125 | 5 |

Installation Instructions

4.1

Front Filler Panels:

Mount Front filler by sliding supplied M8x20 hex head bolts into the Alu-Cabin Front loadbar, and fastening the front filler to the the frame using the supplied M8 Nylock Nuts.

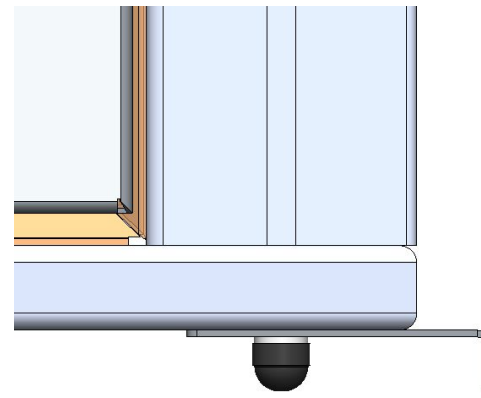
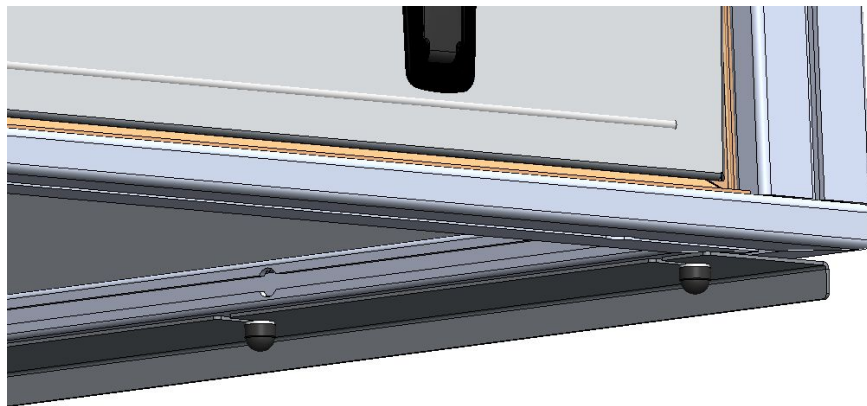

Installation Instructions

4.2

Front Filler Panels:

With everything fastened securely apply a bead of Black Sikaflex to seal the front filler panels.

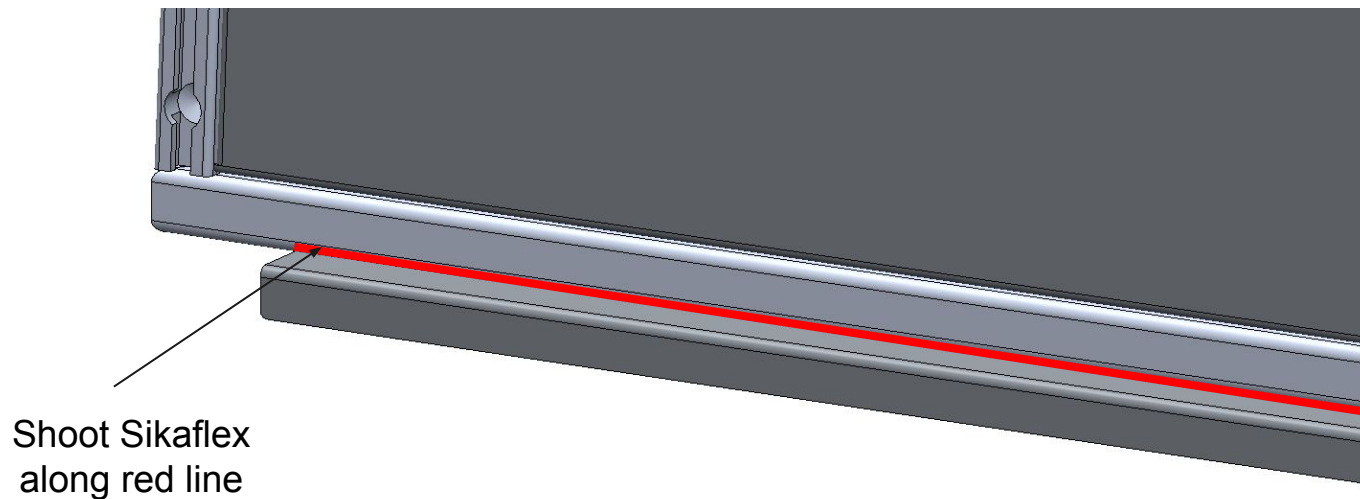

Installation Instructions

5

Install the EPDM Foam to the Alu-Cabin:

Follow instructions here: [EPDM Foam for Canopy Campers Fitment Instruction](#)

Apply the foam so that it seals over the front filler as well.

With the foam in place drop the Canopy Camper on to the load bin and align it so that it is centered.

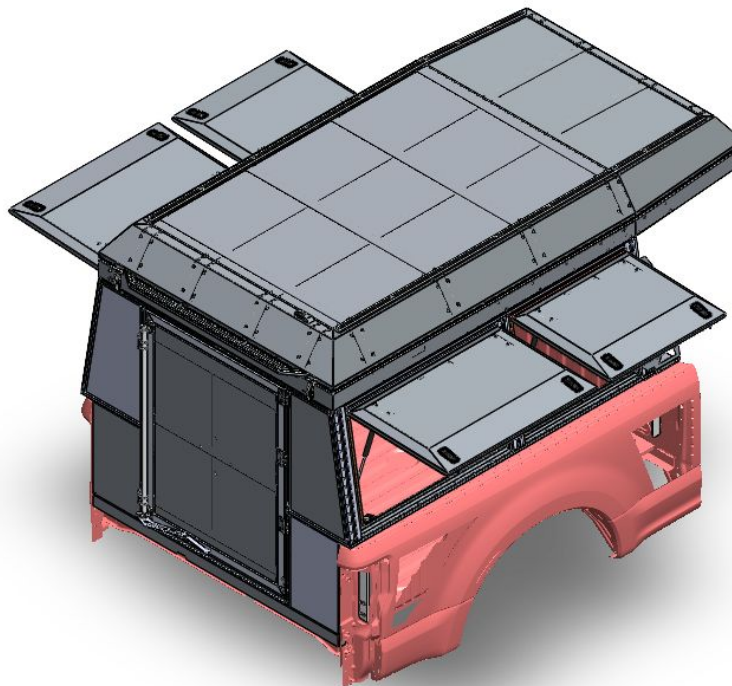

Installation Instructions

6

Connect rear filler panel assembly and base unit as shown:

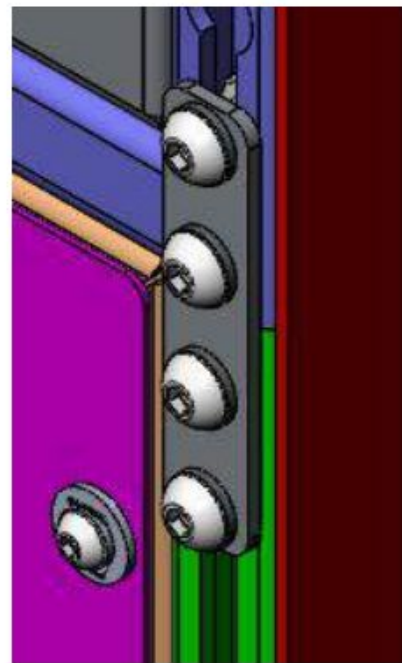

OUTER MOUNTING ON BOTH JOINTS

Installation Instructions

7.1

Connect rear filler panel assembly and base unit as shown:

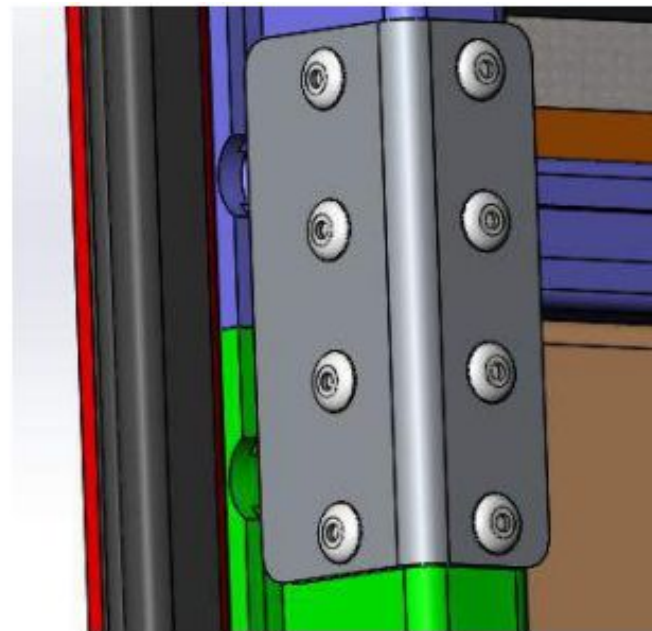
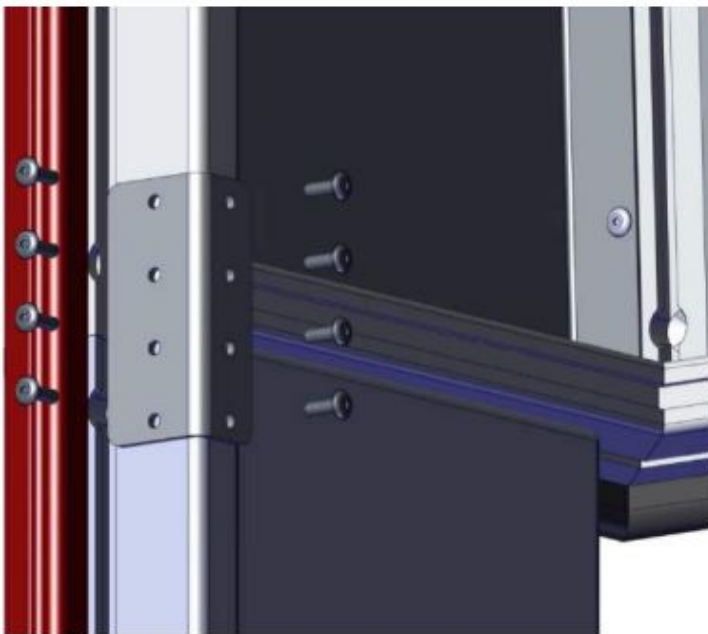

INNER MOUNTING ON BOTH JOINTS

Installation Instructions

8

Rebate and Door Assembly:

Fit rear door rebate with Ø4.8 x 15 sealed countersunk rivets as shown.

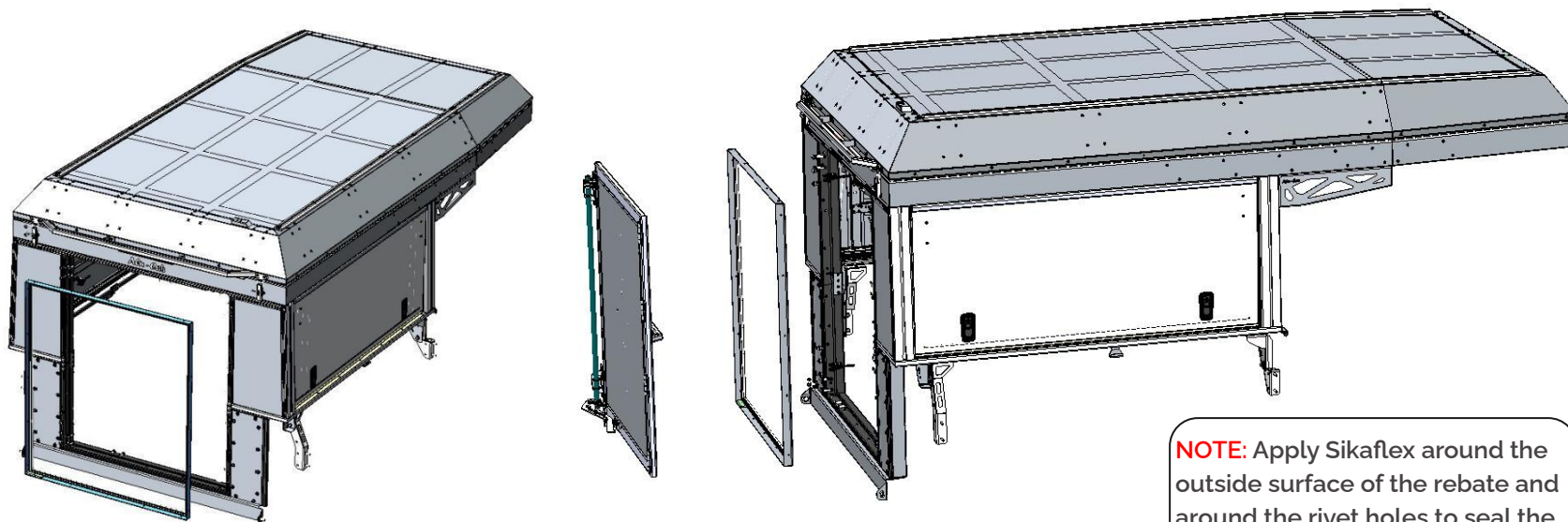

NOTE: Apply Sikaflex around the outside surface of the rebate and around the rivet holes to seal the rebate.

Installation Instructions

8.1

Rebate and Door Assembly:

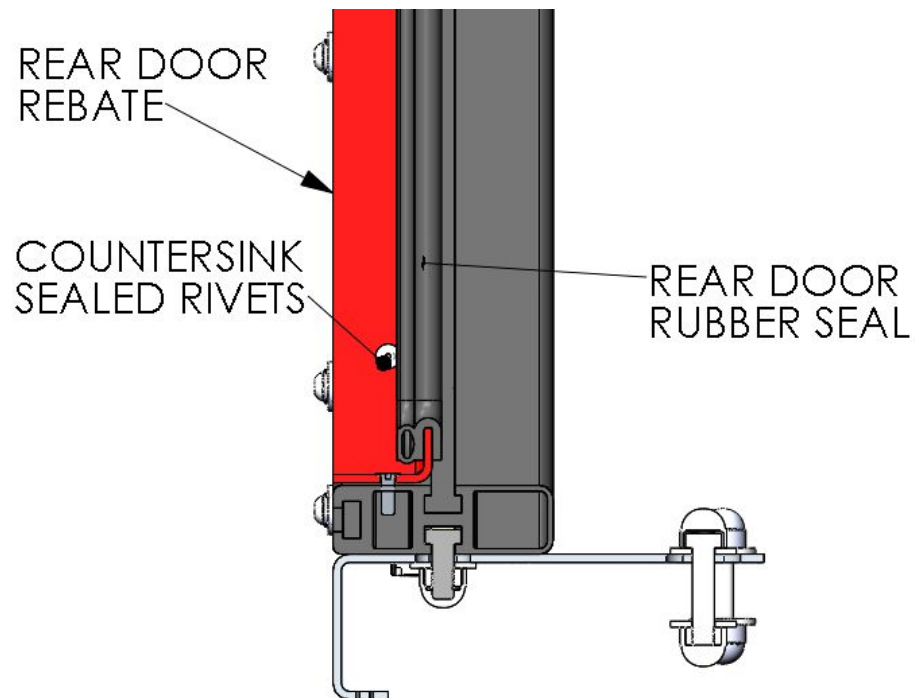

Installation Instructions

9

Rear door mounting:

Fit rear door by mounting 4 x Butt hinges to camper frame as shown. Centre rear door, top to bottom and the hinge centres left to right. Also mount the door lock to the camper frame.

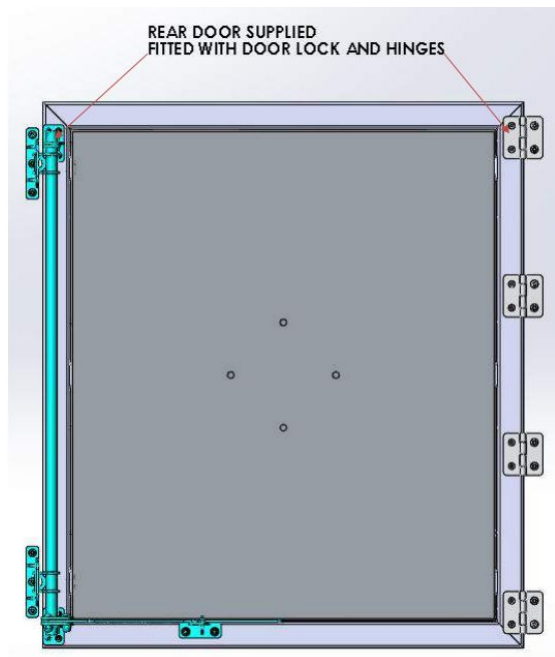

7

Attach hinges and lock to camper frame:

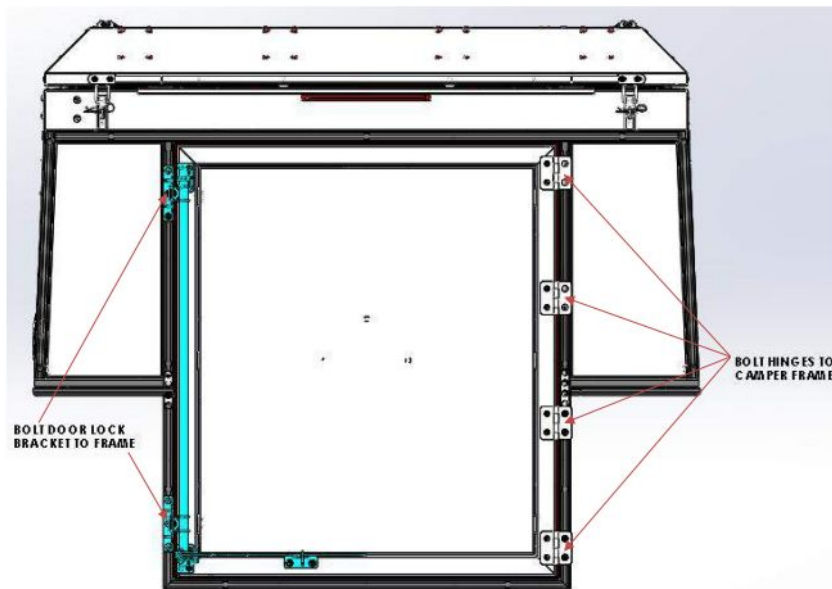

Installation Instructions

10

Mounting Brackets Setup:

With the canopy camper in position you can install the mounting brackets. The Mounting kit of the Nissan Frontier is made up of 6 of the same brackets. The left and right sides are mirrors of each other. Please ensure that the brackets are evenly spaced across the rail as indicated in the image below.



Installation Instructions

10.1

Mounting Brackets Setup:

1. Assemble the nut plate, nut plate, cup squares and elastic band.
2. Slide three nut plate assemblies into the Nissan Utili-Track® Left Channel, and three into the Right Channel.
3. Slide two M8x20 hex head bolts into the Canopy Camper nut slot frame so that they correspond with the cup square in the nut plate assembly. Repeat this for each nut plate assembly.

1



3

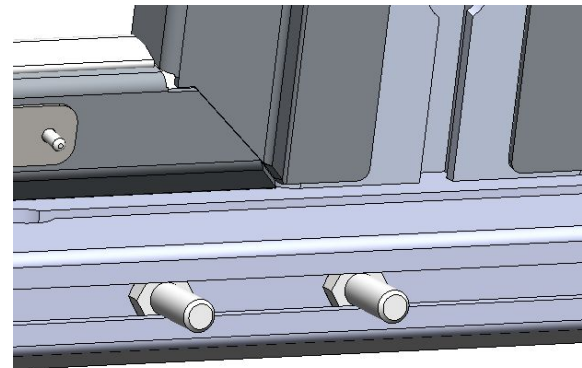

Installation Instructions

10.1

Mounting Brackets Setup:

4. Place the NISSAN FRONTIER 2022+ MOUNTING PLATE over the bolts in the Canopy Camper frame and the ones in the nut plate.
5. Use the supplied M8 flat washers, nylock nuts and nut caps to the bracket installation.

5



Installation Instructions

11

Sealing canopy to base:

Use Sikaflex where there are shut / joining lines between parts that are not welded

Red line indicate when Sikaflex needs to be applied to seal between assembled parts

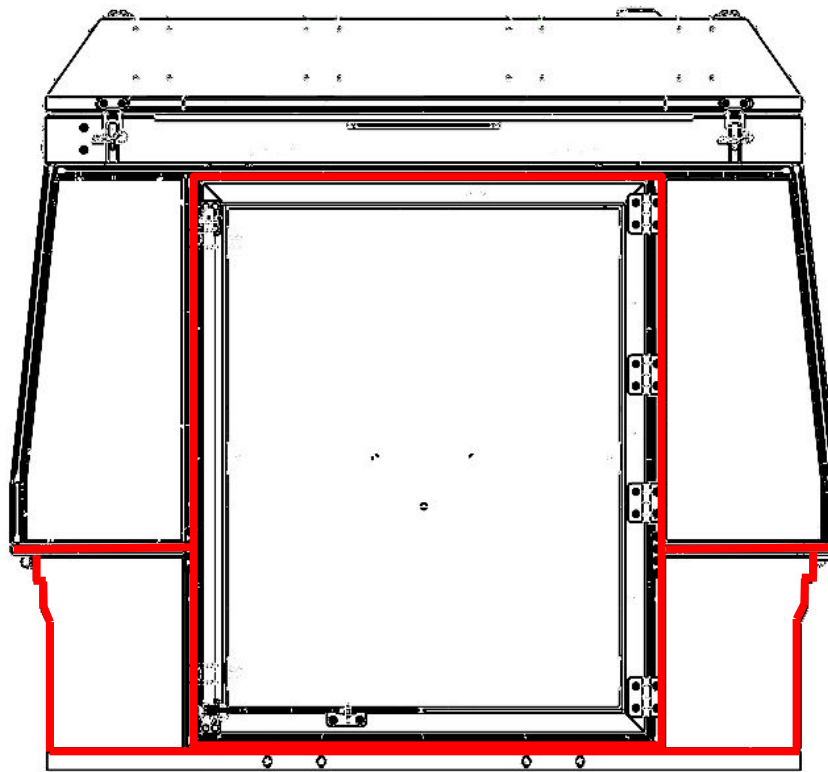

Installation Instructions

- 12 **Sealing canopy to base:**
Apply Sikaflex along the red line to the front filler to seal the filler to the load bin.

Image is from inside the cab, looking underneath the front filler.

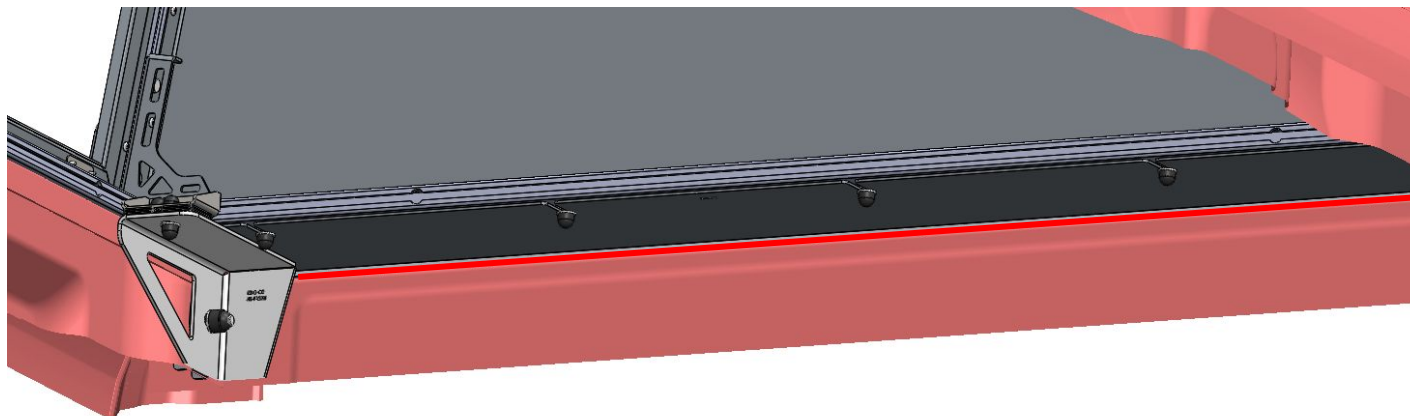

Installation Instructions

12

Sealing canopy to base:

Use Sikaflex where there are shut / joining lines between parts that are not welded.

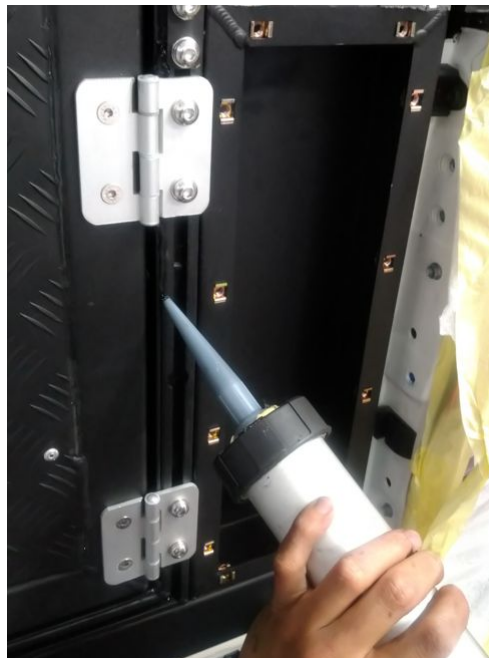

Dip one's finger into soapy water and smooth over the sealant by gently running a finger over the bead.

Installation Instructions

13

OPTIONAL Sealing canopy to vehicle body:

Use Sikaflex between the Canopy Camper and the vehicle body

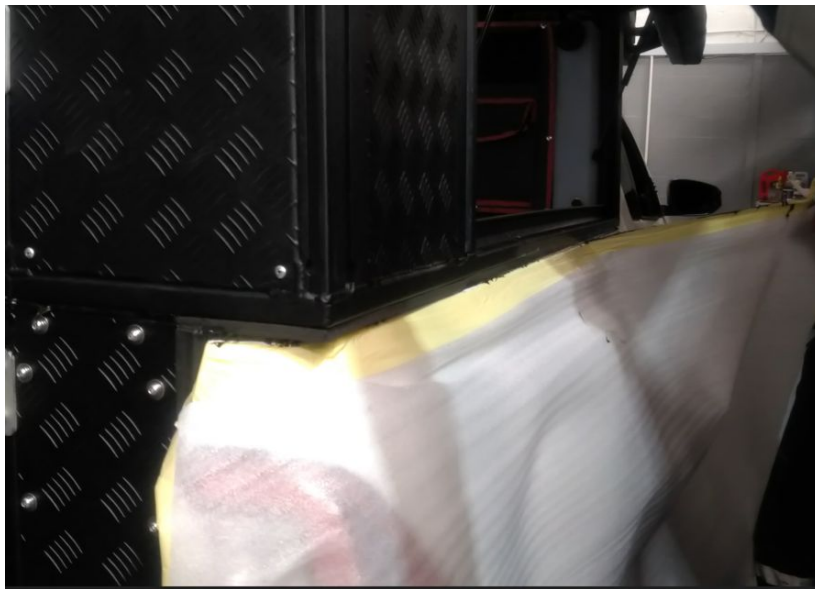

Ensure that the rest of the vehicle is covered against any extra sealant or spillage when sealing the canopy camper to the vehicle's body.

NOTE: This step is only done at the customer's approval.

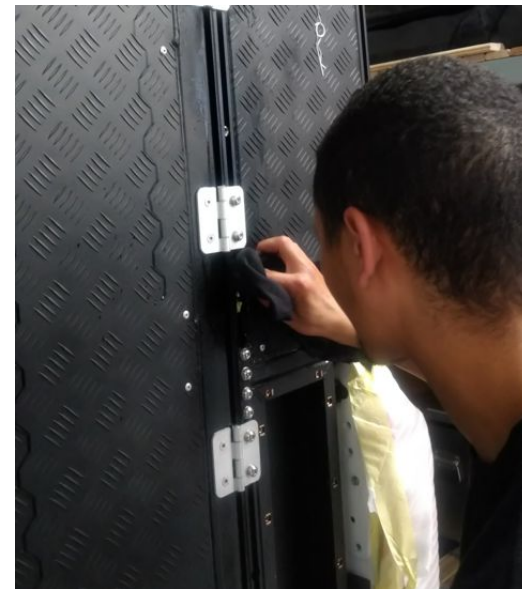

Use Turpentine and a cloth to clean away any extra sealant or mess

Disclaimer

All rights reserved. No part of this website may be reproduced, translated, stored in a retrieval system, or transmitted, in any form or by any means, electronic, mechanical, photocopying, recording or otherwise, without prior written permission of the owner.

Review all instructions information carefully before installation.

Any damages, direct or incidental to the installer and/or property due to incorrect installation of any parts are the responsibility of the installer. Due to the various applications and fitment options available, the responsibility lies with the user to ensure all mounting points are secure and tight before every trip.

If unsure, consult with your Distributor regarding the operations of our products.

Users are advised to be mindful of the load they are carrying and drive in accordance with road conditions.

WARNING

Always wear appropriate PPE (Personal protection equipment) when fitting our products. Although the mounting kit is designed to be DIY, if you have any doubts or concerns, contact an accredited fitment centre to carry out the work. Alu-Cab will not be liable for any injury to persons, and/or damage to products and/or vehicles.

While Alu-Cab Holdings takes reasonable measures to ensure that the contents of this Website are accurate and complete, Alu-Cab Holdings makes no representations or warranties, whether express or implied, as to the quality, timeliness, operation, integrity, availability or functionality of this Website or as to the accuracy, completeness or reliability of any information on this Website. Alu-Cab Holdings reserves the right to make changes, corrections and/or improvements to the information and to the products and programs described in such information, at any time without notice.

Alu-Cab Holdings will use reasonable endeavours to maintain the availability of the Website, except during scheduled maintenance periods, and reserves the right to discontinue providing the Website or the service or any part thereof with or without notice to you. Any person who accesses this Website or relies on this Website or on the information contained in this Website does so at his or her own risk.

Occasionally, at our discretion, we may include or offer third-party products or services on our website. These third-party sites have separate and independent privacy policies. We therefore have no responsibility or liability for the content and activities of these linked sites. Nonetheless, we seek to protect the integrity of our site and welcome any feedback about these sites.